



EN Operator's manual
220-240V Electric Lawn Mower

Model :
LPPE10-L-EU



EN

For customer service please find all information on www.senixtools.com.

CAUTION: BEFORE USING THIS PRODUCT, READ THIS MANUAL AND FOLLOW ALL ITS SAFETY RULES AND OPERATING INSTRUCTIONS.

ORIGINAL INSTRUCTIONS

• SAFETY & INTERNATIONAL SYMBOLS •

This operator's manual describes safety and international symbols and pictographs that may appear on this product. Read the operator's manual for complete safety, assembly, operating and maintenance and repair information.



Caution/ Warning.
WARNING-To reduce the risk of injury,
user must read instruction manual.



Beware of sharp blades. Blades continue
to rotate after the motor is switched
off - Remove plug from mains before
maintenance or if cord is damaged.



Keep bystanders away.



Keep the flexible supply cord away from the
cutting blades.



Wear eye protection.



Wear ear protection.



Wear slip-resistant foot protection.



Wear gloves.



Wear protective overalls.



Slip on slope hazard – Use extra caution
when mowing on slopes to prevent slip and
fall accidents.



Blades continue to rotate after machine is
switched off.



Beware of sharp elements.



Recycling symbol.

IPX4

Protection against splashed water from all
directions.

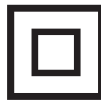

Class II - Double insulation.



Guaranteed sound power level value in
96 dB(A)



The product complies with the applicable
European directives and an evaluation
method of conformity for these directives was
done



DANGER!

Rotating blades. Keep hands and feet
away.

TABLE OF CONTENTS

SAFETY.....	2
KNOW YOUR UNIT.....	6
SPECIFICATIONS*	7
ASSEMBLY.....	8
OPERATION.....	9
MAINTENANCE.....	11
CLEANING AND STORAGE.....	12
TROUBLESHOOTING.....	13
PARTS.....	14

SAFETY

SAFETY WARNINGS IMPORTANT SAFETY INSTRUCTIONS



WARNING:

Read all safety warnings and all instructions. Failure to follow the warnings and instructions may result in electric shock, fire and/or serious injury. **Save all warnings and instructions for future reference.**

1. Children should be supervised to ensure that they do not play with the mower.
2. Read the instructions carefully. Be familiar with the controls and the correct use of the machine.
3. Never allow children or people unfamiliar with these instructions to use the mower. Local regulations can restrict the age of the operator.
4. Never operate the mower while people, especially children, or pets are nearby.
5. Keep in mind that the operator or user is responsible for accidents or hazards occurring to other people or their property.
6. While operating the mower, always wear substantial footwear and long trousers. Do not operate the mower when barefoot or wearing open sandals. Avoid wearing clothing or jewelry that is loose fitting or that has hanging cords or ties. They can be caught in moving parts.
7. Always wear protective goggles to protect your eyes from injury when using power tools. It is an employer's responsibility to enforce the use of appropriate safety protective equipments by the tool operators and by other persons in the immediate working area.
8. Do not switch on the unit until it has been completely assembled. Before switching on the tool, always check the connection cable for signs of damage; only an undamaged connection cable may be used. Damaged connection cables are highly dangerous!
9. The electrical data of the electrical supply must be the same as that indicated in the rating plate of this tool. Please do not use the tool if the electrical data is different.
10. Insert the main plug of the unit connection cable into the combined switch/plug.
11. Secure with the cable grip. The loop of the mains cable must be long enough for the cable grip to slide from one side to the other.
12. Thoroughly inspect the area where the machine is to be used and remove all objects which can be thrown by the machine.
13. Before using, always visually inspect to see that the cutting means, blade nut and the blade assembly are

- not worn or damaged. Replace worn or damaged components in sets to preserve balance. Replace damaged or unreadable labels.
14. Before use check the supply and extension cord for signs of damage or aging. If the cord becomes damaged during use, disconnect the cord from the supply immediately. **DO NOT TOUCH THE CORD BEFORE DISCONNECTING THE SUPPLY**. Do not use the machine if the cord is damaged or worn.
 15. Operate the mower only in daylight or in good artificial light.
 16. Avoid operating the mower in wet grass.
 17. Never operate the mower in the rain.
 18. Always keep a firm hold on the handle.
 19. Always be sure of your footing on slopes.
 20. Walk, never run.
 21. Mow across the face of slopes, never up and down.
 22. Exercise extreme caution when changing direction on slopes.
 23. Do not mow excessively steep slopes.
 24. Use extreme caution when reversing or pulling the machine towards you.
 25. Stop the blade(s) if the machine has to be tilted for transportation when crossing surfaces other than grass, and when transporting the machine to and from the area to be used.
 26. Never operate the machine with defective guards or shields, or without safety devices, for example deflectors and/or grass collector, in place.
 27. Switch on the motor carefully according to instructions and with feet well away from the blade(s).
 28. Do not tilt the machine when switching on the motor, except if the machine has to be tilted for starting. In this case, do not tilt it more than absolutely necessary and lift only the part, which is away from the operator.
 29. Do not start the machine when standing in front of the discharge opening.
 30. Do not put hands or feet near or under rotating parts.
 31. Keep clear of the discharge opening at all times.
 31. Do not transport the machine while the power source is running.
 33. Stop the machine, and remove the disabling device. Make sure that all moving parts have come to a complete stop whenever you leave the machine, before clearing blockages or unclogging chute, before checking, cleaning or working on the machine, after striking a foreign object.
 34. Inspect the machine for damage and make repairs before restarting and operating the machine; if the machine starts to vibrate abnormally (check immediately), inspect for damage, replace or repair any damaged parts, check for and tighten any loose parts.
 35. Pull the plug from the socket:
 - Whenever you leave the machine;
 - Before clearing a blockage;
 - Before checking, cleaning or working on the appliance; after striking a foreign object. Inspect the appliance for damage and make repairs as necessary;
 36. Keep all nuts, bolts, and screws tight to be sure the appliance is in safe working condition.
 37. Check the grass box frequently for wear or deterioration.
 38. Replace worn or damaged parts for safety.
 39. On machines with multi blade, take care as rotating one blade can cause other blades to rotate.
 40. Be careful during adjustment of the machine to prevent entrapment of the fingers between moving blades and fixed parts of the machine.
 41. For rotary mowers, ensure that only replacement cutting systems of the right type are used.

42. Replace worn or damaged parts for safety. Use only genuine replacement parts and accessories.
43. When servicing the blades be aware that, even though the power source is switched off, the blades can still be moved.
44. The extension cable, plug and socket must be watertight and intended for outdoor use.
45. Always allow the machine to cool down before storing
46. The machine should be supplied via a residual current device (RCD) with a tripping current of not more than 30 mA.

Caution: An inadequate extension cable can be dangerous and can cause accidents. Please contact a qualified electrician for advice if in any doubt. Even if you are operating this product in accordance with the provisions, residual risks will still remain. The following dangers can arise in connection with the structure and design of this product:

40. Health defects resulting from vibration emissions if the product is used over longer period of time or not adequately managed and properly maintained.
41. Injuries and damage to property to due to broken accessories or hidden objects that are suddenly dashed.

REMOVE THE PLUG FROM THE SOCKET

- 1) Whenever you leave the machine.
- 2) Before clearing a blockage.
- 3) Before checking, cleaning or working on the machine.
- 4) After striking a foreign object. Inspect the machine for damage and make repairs as necessary. If the machine starts to vibrate abnormally (check immediately).

GUIDELINES FOR USING EXTENSION CORDS

Make sure your extension cord is in good condition.

When using an extension cord, be sure to use one heavy enough to carry the current your product will draw. An undersized cord will cause a drop in line voltage resulting in loss of power and overheating.

Always replace a damaged extension cord or have it repaired by a qualified person before using it.

Protect your extension cords from sharp objects, excessive heat and damp/wet areas.

Use a separate electrical circuit for your tools. This circuit should be protected with the appropriate time-delayed fuse.

Before connecting the motor to the power line, make sure the switch is in the OFF position and the electric voltage is rated the same as the voltage stamped on the motor nameplate.

Running at a lower voltage will damage the motor.

CAUTION: You should only use extension cords for outdoor use, PVC cord ordinary duty with a cross sectional area not less than 1.5 mm².

INTENDED USE

This lawn mower is intended for private residential use to cut grass in small lawns and gardens. This lawn mower is not intended to cut grass in public parks, playing fields, farms, or forests. Do not use this lawn mower for any application other than that for which it is intended.

RESIDUAL RISKS

Even if you are operating this product in accordance with the provisions, residual risks will always still remain. The following dangers can arise in connection with the structure and design of this product:

1. Health defects resulting from vibration emission if the product is being used

over longer period of time or not adequately managed and properly maintained.

2. Injuries and damage to property to due to broken accessories or hidden objects that are suddenly dashed.
3. Injuries and damage to property to due to thrown and fallen objects.
4. Prolonged use of this product expose the operator to vibrations and may produce 'whitefinger' disease. In order to reduce the risk, please wear gloves and keep your hands warm. If any of the 'whitefinger' symptoms appear, seek medical advice immediately. 'Whitefinger' symptoms include: numbness, loss of feeling, tingling, pricking, pain, loss of strength, changes in skin colour or condition. These symptoms normally appear in the fingers, hands or wrists. The risk increases at low temperatures.



WARNING:

This product produces an electromagnetic field during operation! This field may under some circumstances interfere with active or passive medical implants! To reduce the risk of serious or fatal injury, we recommend persons with medical implants to consult their physician and the medical implant manufacturer before operating this product!

KNOW YOUR UNIT

APPLICATIONS

Model :LPPE10-L-EU

As a lawn mower:

- Cutting grass in small lawns and gardens.

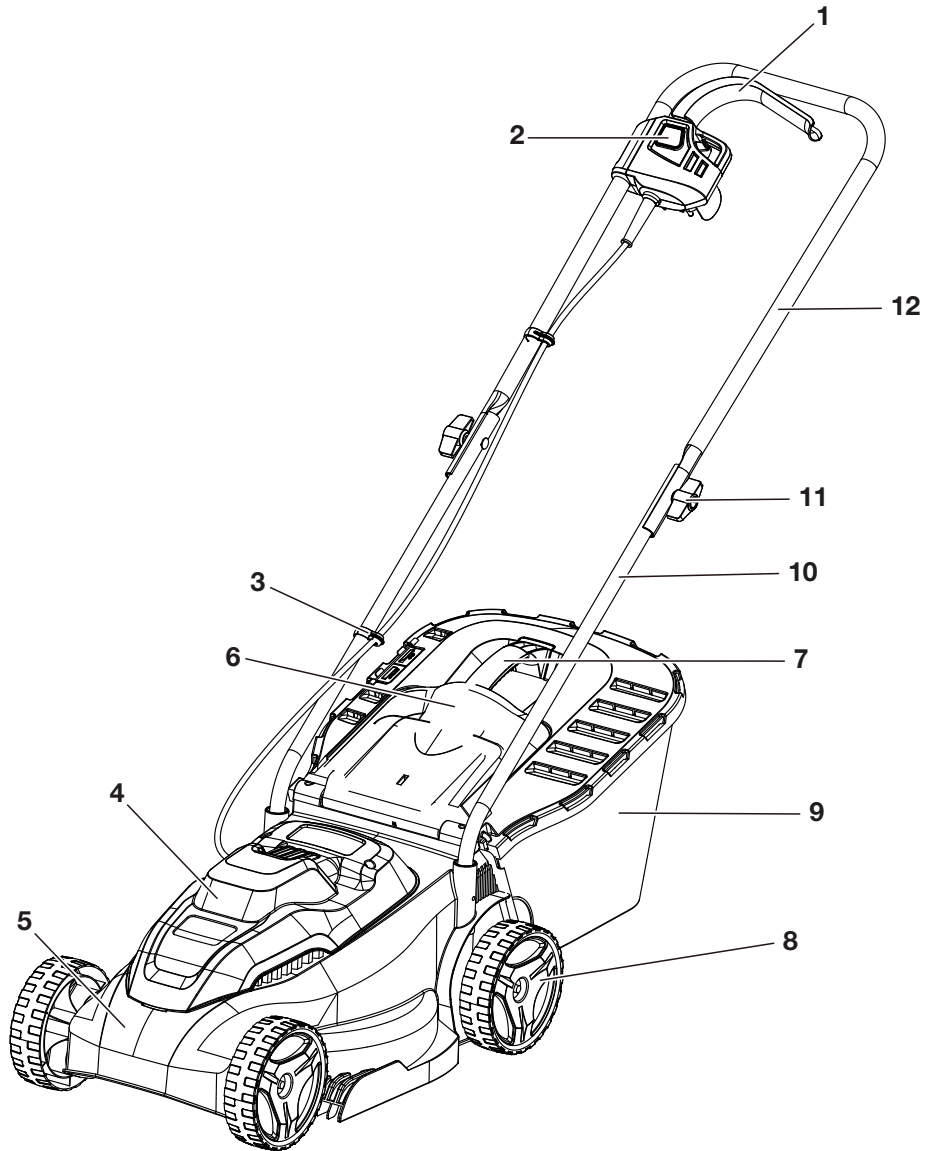

1	Trigger	7	Grass Collector Handle
2	Safety Button	8	Wheel
3	Cable Clip	9	Grass collection bag
4	Motor Housing	10	Lower Handle
5	Cutting Deck	11	Handle Fixing Knob
6	Grass Flap	12	Upper Handle

SPECIFICATIONS*

Model	LPPE10-L-EU
Voltage	220-240V 50Hz
No-load speed	3800 min ⁻¹
Rated power input	1000 W
Cutting width	320 mm
Cutting height	25-65 mm
Collector capacity	30 L
Weight	5.8 kg
Sound pressure level	83.9 dB(A)
Uncertainty K	3 dB(A)
Measured sound power level	94.6 dB(A)
Uncertainty K	0.44 dB(A)
Guaranteed sound power level	96 dB(A)
Vibration level(K=1.5 m/s ²)	1.47 m/s ²

Information:

The declared vibration and noise total value has been measured in accordance with a standard test method and may be used for comparing one tool and noise with another;

The declared vibration and noise total value may also be used in a preliminary exposure assessment.

The vibration emission during actual use of the power tool can differ from the declared total value depending on the ways in which the tool is used; and it may be necessary to identify safety measures to protect the operator that are based on an estimation of exposure in the actual conditions of use (taking into account all parts of the operating cycle such as the times when the tool is switched off and when it is running idle in addition to the trigger time).

* All specifications are based on the latest product information available at the time of printing. We reserve the right to make changes at any time without notice.

ASSEMBLY

This product requires assembly. Carefully remove the product and any accessories from the box. Inspect the product carefully to make sure no breakage or damage occurred during shipping.

Do not discard the packing material until you have carefully inspected and satisfactorily operated the product. If any parts are damaged or missing, please call 49 (0)40 854 10 40 - 14 for assistance.

! WARNING:

Do not use this product if it is not completely assembled or if any parts appear to be missing or damaged. Use of a product that is not properly and completely assembled could result in serious personal injury.

HANDLE ASSEMBLY

1. Insert both lower handles into the holes in the deck and secure with the supplied screws, ensuring the fixing holes on the deck line up with the fixing holes of the lower handles (Fig. 1a).
2. Slide the cable tidy around the upper handle assembly. Attach the upper handle to the two lower handles, using the handle fixing knobs, bolts. Ensure they are secured (Fig. 1b).
3. The main module of the switch box group is located at the right of the upper handle and lightly push the switch box group. After locking, confirm whether the installation is complete.
4. Clip the cable clip on the handle. Clip the cord into the cable clip (Fig. 1c).

NOTE: Handle fixing knobs should be located on inside of handle assembly.

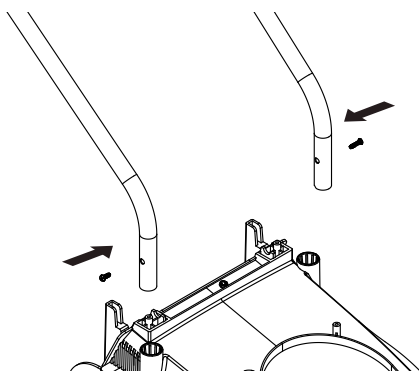

Fig. 1a

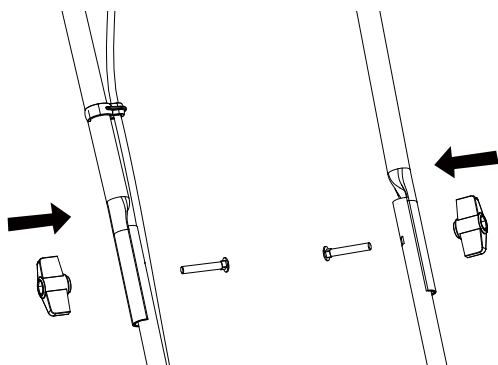

Fig. 1b

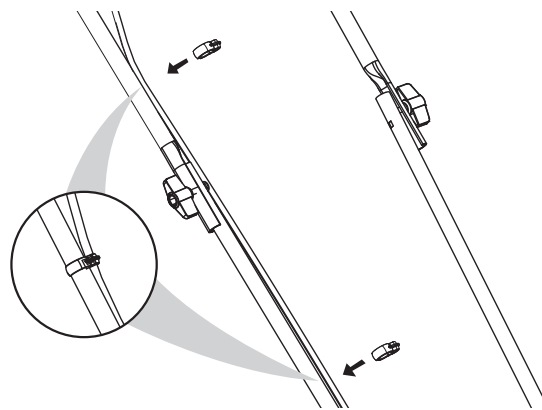

Fig. 1c

! WARNING:

To avoid serious personal injury and damage to the unit, shut the unit off before removing or installing an attachment.

GRASS COLLECTOR ASSEMBLY AND FITTING

The grass collector prevents grass clippings being thrown across your lawn as you mow.

1. Insert the grass collector handle into the holes on the top of grass collector until it clicks in the grass collector.
2. Lift the collector flap with one hand. With the other hand hold the grass collector by the handle and hook it (Fig. 2).

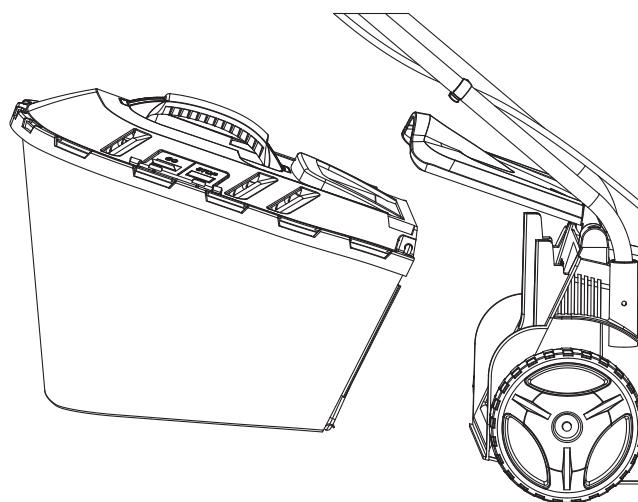

Fig. 2

! WARNING:

Before using any attachment, read and understand the manual that came with the attachment. Follow all safety information contained within.

! WARNING:

In some countries regulations define at what time of the day and on what special days products are allowed to be used and what restrictions apply! Ask your community for detailed information and observe the regulations in order to preserve a peaceful neighborhood and avoid committing administrative offences.

! WARNING:

Before connecting to the mains supply, always check the switch is in the off position!

ADJUSTING THE CUTTING HEIGHT

This electric lawn mower is equipped with a 3-position height adjustment system to tailor grass cutting heights of 25 to 65 mm. To obtain your desired cutting height, by raising or lowering the front and rear wheels individually.

To set the wheel height, turn the machine onto its side. Locate the wheel axle and adjust to the relevant height location in the deck. Repeat again with the rear axle, ensuring both axles are located fully before attempting to cut. All the wheels must be located at the same height to ensure a level and even cut (Fig. 3).

NOTE: A medium height of cut is recommended for most lawns. The quality of your mowing will suffer, and collection will be poor if you cut too low.

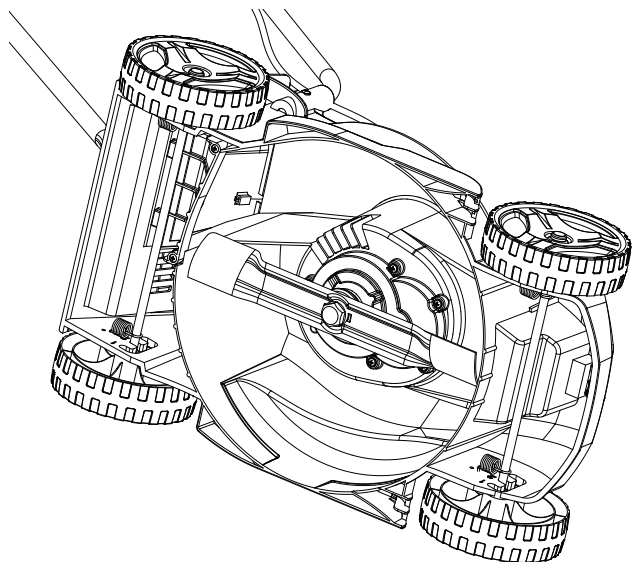

Fig. 3

STARTING THE MOTOR

1. Plug the machine into the electric supply, ensuring it meets the recommended requirements. Electrical power should be supplied via a residual current device (RCD) with a tripping current of not more than 30 mA.
2. Press the safety button and pull the trigger towards the top handle. The mower will start, and blade immediately rotates. When operating the machine, you can release the safety button and the machine will operate (Fig. 4).

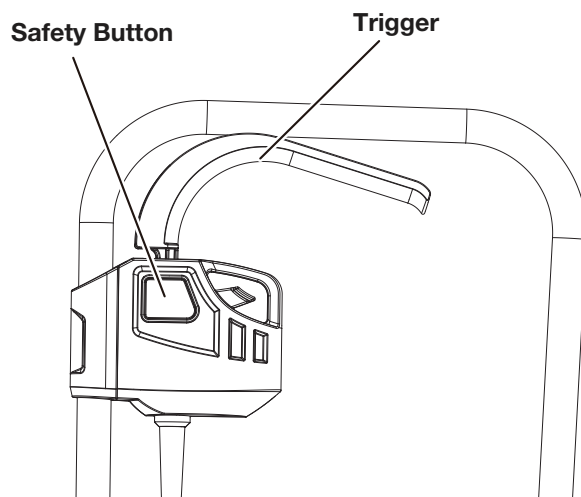

Fig. 4

STOPPING THE MOTOR

To stop the mower, release the trigger.

! WARNING:

The blade will still rotate for a small time, after the trigger has been released!

GRASS COLLECTION BAG VOLUME INDICATOR

1. If the grass collector is empty or is not completely full with grass, the grass indicator flap will remain open (I1) (due to the flow of air) or will flutter open and close as the grass accumulates in the bag.
2. When the grass collector reaches its maximum capacity, the grass indicator flap will remain closed (I2) (due to the restricted air flow). This signals that it is time to empty the bag (Fig. 5).

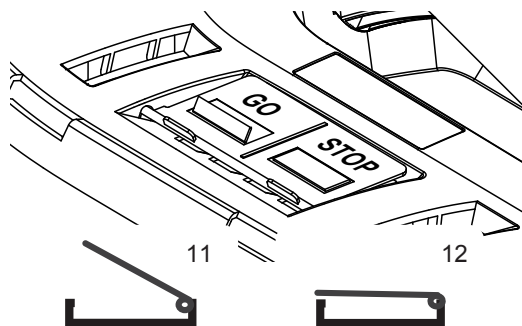

Fig. 5

MOWING TIPS

For best results cut your lawn in alternative directions switching direction each time you cut. Cut your lawn at an equal and same height. Slightly overlap your cutting lines (Fig. 6).

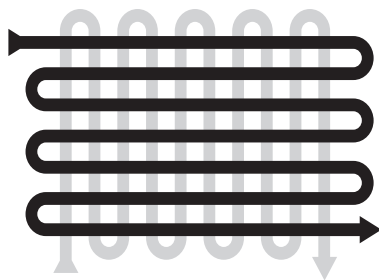

Fig. 6

MAINTENANCE

! WARNING:

Before cleaning, repairing, or inspecting the lawn mower, disconnect the power supply to the unit and verify that all moving parts have come to a complete stop.

Maintain this product regularly and carefully! If the product is improperly maintained, it may fail at its intended task, which may produce fatal consequences.

! WARNING:

Wear protective clothing and observe all safety instructions to prevent serious personal injury.

GENERAL

Always keep the lawn mower clean and free of grass, dirt, or other debris.

Keep the handles dry, clean, and free of oil and grease.

After each cutting session, remove accumulated grass clippings and debris using either a dry cloth or hand brush. You may also clean the equipment with a damp cloth. Do not use cleaning agents or harsh solvents as they may damage the equipment's plastic components. Make sure that no water penetrates the equipment's interior as intake of water can destroy the switch/plug mechanism and the electric motor.

Do not clean the lawn mower with running water, particularly with high-pressure water.

Check all nuts, bolts, and screws for proper tightness before each use.

Frequently inspect the grass collection bag for signs of wear and replace immediately with a genuine part damage is found.

Replace excessively worn or damaged parts immediately.

LUBRICATION

All of the bearings in this product are lubricated with a sufficient amount of high grade lubricants for the life of the unit under normal operation conditions. Therefore, no further lubrication of the bearings is needed.

AT THE BEGINNING AND END OF EACH MOWING SEASON:

- Lubricate the springs on the rear discharger door with light oil.
- Remove the blade and the blade rotor assembly and lubricate the motor shaft with light oil or engine oil.

BLADE MAINTENANCE

! WARNING:

The mower blade is sharp and can cause severe personal injury if handled incorrectly.

Wrap the blade or wear protective gloves, and use extra caution when handling.

The steel blade is designed to provide a fine cut in long or tough grass. Deterioration in the quality of cut indicates blade wear or damage.

! WARNING:

An excessively vibrating lawn mower indicates that the blade is not properly balanced or has become deformed from striking an object. In this case, the blade must be repaired or replaced. Please follow the proper maintenance procedures for blade care or call the service center.

BLADE REPLACEMENT

! WARNING:

Wear heavy duty gloves when handling the blade. Only use original replacement parts specified for this lawn mower.

1. Disconnect the electrical supply to the lawn mower.
2. Turn the lawn mower on its side to expose the underside of the blade housing.
3. Wear heavy-duty gloves, or use a cloth to grip the blade.
4. To remove the blade bolt, hold the blade firmly by one hand, and use a spanner wrench to loosen the blade bolt by turning it counterclockwise.
5. Fit the new blade, the washer and the bolt back on following the same steps in reverse order (Fig. 7).

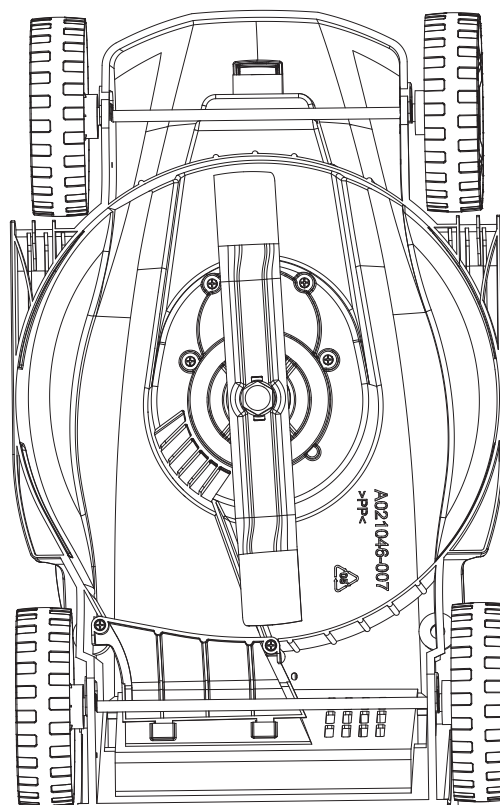

Fig.7

CLEANING AND STORAGE

CLEANING

WARNING:

Always switch the product off, disconnect the power supply to the product and let the product cool down before performing inspection, maintenance and cleaning work!

Use a small brush to clean the outside of the unit. Do not use strong detergents. Household cleaners that contain aromatic oils such as pine and lemon, and solvents such as kerosene, can damage plastic. Wipe off any moisture with a soft cloth. Inspect the product before and after each use for worn and damaged parts. Do not operate it if you find worn and damaged parts.

NOTE: If the cutting blade is blocked by foreign objects during the operating, stop the product, wait for the cutting blade stops entirely, remove the foreign objects and clean the cutting blade.

WARNING:

Only perform repairs and maintenance work according to these instructions! All further works must be performed by a qualified specialist!

STORAGE

1. Clean the product as described above.
2. Store the product and its accessories in a dark, dry, frost-free, well-ventilated place.
3. Always store the product in a place that is inaccessible to children. The ideal storage temperature is between 10 °C and 30 °C.
4. We recommend using the original package for storage or covering the product with a suitable cloth or enclosure to protect it against dust.

TRANSPORT

1. Clean the product as described above.
2. Always carry the product by its handle.
3. Protect the product from any heavy impact or strong vibrations which may occur during transportation in vehicles.
4. Secure the product to prevent it from slipping or falling over, damage or injury.

DISPOSAL

Waste product should not be disposed of with household waste. Please recycle where facilities exist. Check with your local authority or retailer for recycling advice.

During the operation, the leaf or tree branches may be cut by the unit, users should clean these objects to protect environment.



WEEE symbol. Tools that are no longer usable should not be disposed of with household waste but in an environmentally friendly way. Please recycle where facilities exist. Check with your local council authority for recycling advice.

TROUBLESHOOTING

PROBLEM	REMEDY
Product does not start	Unplug the unit from the power source and check that the blade is able to rotate freely. If the lawn mower was previously in use, let the motor cool down because the electrical brake could still be engaged.
	Check mains, extension cord, and circuit-breaker (fuse).
	Start lawn mower on short grass or in a previously mowed area and tilt back.
	Correct the cutting height.
Product power drops	Check that you are using a suitable extension cord of proper gauge and length.
	Air vents are blocked.
Product performance drops	Correct the cutting height.
	Clean discharge channel/housing.
	Replace or sharpen mowing blade (contact an authorized service center).
Grass collection bag not filling sufficiently	Correct the cutting height.
	Allow the lawn to dry.
	Clean the grille on the grass collection bag.
	Clean the discharge channel/housing.

If further assistance is required, take the unit to a qualified service dealer.

PARTS

Model: LPPE10-L-EU

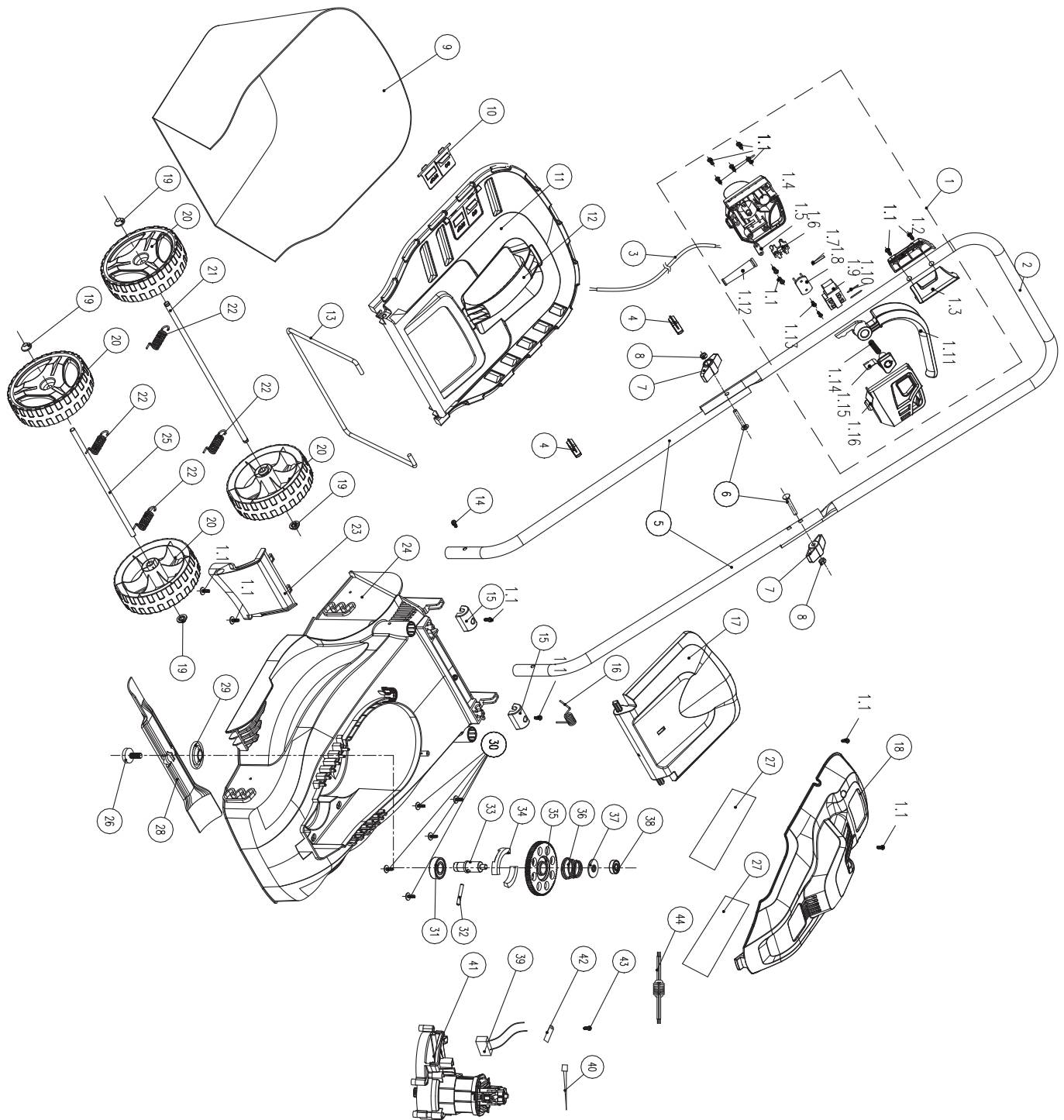

PARTS

No.	Part #	Description	Qty.
1	199075000410	Switch Box Assembly	1
1.1	8SJAB40-16D	Self-Tapping Screw	9
1.2	202083001125	Cover	1
1.3	8020-512011-0000120	Switch box cover	1
1.4	202113000026	Switch Box	1
1.5	8184-302201-0001710	Cable press plate	1
1.6	8421-512101-0101620	Plug	1
1.7	8342-463002-0000000	Push The Button On The Spring	1
1.8	8187-512401-0100120	Fixed plate	1
1.9	8042-660102-0000011	Switch	1
1.10	8413-513101-0000020	Connecting Wire	2
1.11	202004001071	trigger	1
1.12	8332-532101-0100020	Cable Sheath	1
1.13	8SNAB30-08D	Flange face tapping screw	2
1.14	8342-481501-0000000	Spring	1
1.15	202003001932	Button	1
1.16	8020-512007-0000120	Switch Box	1
2	207300400022	Mower handle	1
3	8422-512001-0000120	Cable	1
4	8204-512101-0000120	Line Deduction	2
5	201061000103	Handle	2
6	8206-660501-0000000	Square Neck Bolt	2
7	207250400027	Knob	2
8	8NH-06D	Type 1 non-metallic insert hex lock nut	2
9	299001000120	Net Bag	1
10	202999001869	Dashboard	1
11	202138000711	Loam Cake	1
12	202024002754	handle	1
13	8292-513901-0000000	Grass Bo Support	1
14	8SNAB50-20D	Cross Groove Flange Screw	2

No.	Part #	Description	Qty.
15	202029000238	Press plate	2
16	8342-513901-0000000	Rear Cover Torsional Spring	1
17	202083001137	Cover	1
18	202030001843	Cover	1
19	8026-513901-0000000	Wheel Cap	4
20	8121-512001-0000120	Wheel	4
21	8081-513902-0000000	Trailing Axle	1
22	8342-513902-0000000	Tension Spring	4
23	202057000035	Guide Plate	1
24	202016003941	cabinet	1
25	8081-513901-0000000	Front Axle	1
26	207220100011	Hexagon Bolt	1
27	8326-512001-0000120	Sponge Mat	2
28	201045000252	blade	1
29	202015000423	Pipe Sleeve	1
30	8SNAB50-16D	Cross Groove Flange Screw	5
31	207390200044	Deep groove ball bearing	1
32	207350200006	Cylindrical Pin	1
33	201025000159	Output shaft	1
34	201028000010	Brake Pads	2
35	201004000423	Wheel Gear	1
36	207010200007	Conical Compression Spring	1
37	207280200007	Flange Shaft Sleeve	1
38	207390200022	Deep groove ball bearing	1
39	8416-534801-0100010	Capacitance	1
40	101001000855	Motor assembly	1
41	236-1006	Nylon cable tie	2
42	8186-481202-0000010	Press plate	1
43	8SNAB30-12D	Flange face tapping screw	1
44	8415-515101-0000010	circular	1