

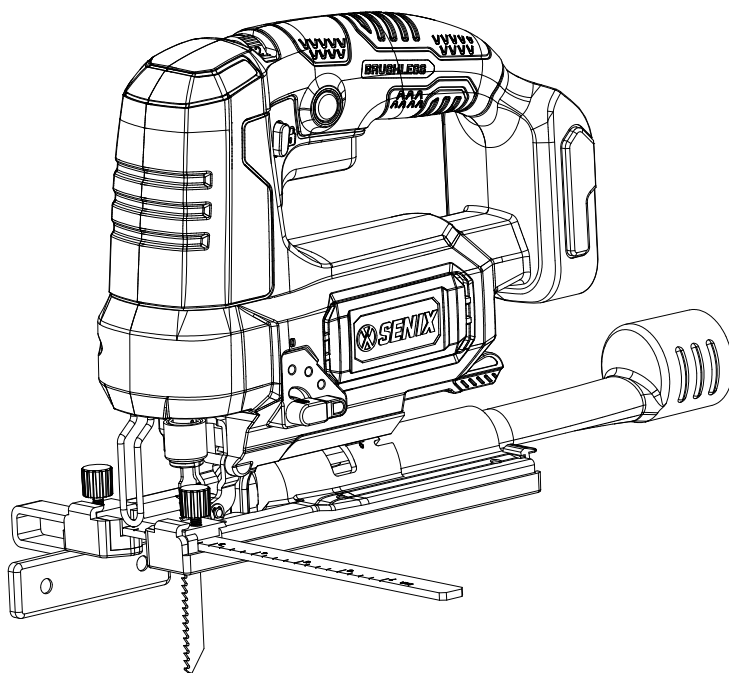

CORDLESS JIG SAW



CAUTION: Before using this tool, please read this manual completely, and follow all operating safety measures.

- SAFETY
- ASSEMBLY
- OPERATION
- MAINTENANCE
- WARRANTY

YAT USA INC. 10506 Bryton Corporate Center Dr, #500 Huntersville, NC 28078
For customer support, please call 1-800-261-3981 or email us at senix.support@yatusa.com

TABLE OF CONTENTS

SAFETY & INTERNATIONAL SYMBOLS.....	2
SAFETY INSTRUCTIONS.....	3
KNOW YOUR UNIT.....	6
SPECIFICATIONS.....	7
ASSEMBLY.....	7
OPERATION.....	8
MAINTENANCE.....	11
TROUBLESHOOTING.....	12
WARRANTY.....	13



Do not disassemble, crush or expose to heat above 212°F (100°C); Never expose the battery to microwaves or high pressures.



Keep bystanders a safe distance away from the work area.



Indoor use only. Only use battery charger indoors.

SAFETY & INTERNATIONAL SYMBOLS

The following table depicts and describes safety symbols that may appear on this product. Read, understand and follow all instructions on the machine before attempting to assemble and operate.



Caution / Warning.



To reduce the risk of injury, user must read instruction manual.



Wear eye protection.



Wear a dust mask.



Wear safety footwear.



Wear protective gloves.



Do not dispose of battery packs in rivers or immerse in water.



Do not dispose of battery packs in fire. They will explode and cause injury.



Use and store the battery within an temperature below 122°F (50°C).



Complies with ETL standards.

SAFETY INSTRUCTIONS

GENERAL POWER TOOL SAFETY WARNINGS



WARNING!

Read all safety warnings, instructions, illustrations and specifications provided with this power tool. *Failure to follow all instructions listed below may result in electric shock, fire and/or serious injury.*

Save all warnings and instructions for future reference.

The term "power tool" in the warnings refers to your mains-operated (corded) power tool or battery-operated (cordless) power tool.

1. Work Area Safety

- a. **Keep work area clean and well lit.** *Cluttered or dark areas invite accidents.*
- b. **Do not operate power tools in explosive atmospheres, such as in the presence of flammable liquids, gases or dust.** *Power tools create sparks which may ignite the dust or fumes.*
- c. **Keep children and bystanders away while operating a power tool.** *Distractions can cause you to lose control of the tool or workpiece.*

2. Electrical Safety

- a. **Power tool plugs must match the outlet. Never modify the plug in any way. Do not use any adapter plugs with earthed (grounded) power tools.** *Unmodified plugs and matching outlets will reduce risk of electric shock.*
- b. **Avoid body contact with earthed or grounded surfaces, such as pipes, radiators, ranges and refrigerators.** *There is an increased risk of electric shock if your body is earthed or grounded.*
- c. **Do not expose power tools to rain or wet conditions.** *Water entering a power tool will increase the risk of electric shock.*
- d. **Do not abuse the cord. Never use the cord for carrying, pulling or unplugging the power tool. Keep cord away from heat, oil, sharp edges or moving parts.** *Damaged or entangled cords increase the risk of electric shock.*
- e. **When operating a power tool outdoors, use an extension cord suitable for**

outdoor use. *Use of a cord suitable for outdoor use reduces the risk of electric shock.*

- f. **If operating a power tool in a damp location is unavoidable, use a residual current device (RCD) protected supply.** *Use of an RCD reduces the risk of electric shock.*

NOTE The term "residual current device (RCD)" can be replaced by the term "ground fault circuit interrupter (GFCI)" or "earth leakage circuit breaker (ELCB)".

3. Personal Safety

- a. **Stay alert, watch what you are doing and use common sense when operating a power tool. Do not use a power tool while you are tired or under the influence of drugs, alcohol or medication.** *A moment of inattention while operating power tools may result in serious personal injury.*
- b. **Use personal protective equipment. Always wear eye protection.** *Protective equipment such as a dust mask, non-skid safety shoes, hard hat or hearing protection used for appropriate conditions will reduce personal injuries.*
- c. **Prevent unintentional starting. Ensure the switch is in the off-position before connecting to power source and/or battery pack, picking up or carrying the tool.** *Carrying power tools with your finger on the switch or energizing power tools that have the switch on invites accidents.*
- d. **Remove any adjusting key or wrench before turning the power tool on.** *A wrench or a key left attached to a rotating part of the power tool may result in personal injury.*
- e. **Do not overreach. Keep proper footing and balance at all times.** *This enables better control of the power tool in unexpected situations.*
- f. **Dress properly. Do not wear loose clothing or jewelry. Keep your hair and clothing away from moving parts.** *Loose clothes, jewelry or long hair can be caught in moving parts.*
- g. **If devices are provided for the connection of dust extraction and collection facilities, ensure these are connected and properly used.** *Use of dust collection can reduce dust-related hazards.*
- h. **Do not let familiarity gained from frequent use of tools allow you to**

become complacent and ignore tool safety principles. *A careless action can cause severe injury within a fraction of a second.*

4. Power Tool Use And Care

- a. **Do not force the power tool. Use the correct power tool for your application.** *The correct power tool will do the job better and safer at the rate for which it was designed.*
- b. **Do not use the power tool if the switch does not turn it on and off.** *Any power tool that cannot be controlled with the switch is dangerous and must be repaired.*
- c. **Disconnect the plug from the power source and/or remove the battery pack, if detachable, from the power tool before making any adjustments, changing accessories, or storing power tools.** *Such preventive safety measures reduce the risk of starting the power tool accidentally.*
- d. **Store idle power tools out of the reach of children and do not allow persons unfamiliar with the power tool or these instructions to operate the power tool.** *Power tools are dangerous in the hands of untrained users.*
- e. **Maintain power tools and accessories. Check for misalignment or binding of moving parts, breakage of parts and any other condition that may affect the power tool's operation. If damaged, have the power tool repaired before use.** *Many accidents are caused by poorly maintained power tools.*
- f. **Keep cutting tools sharp and clean.** *Properly maintained cutting tools with sharp cutting edges are less likely to bind and are easier to control.*
- g. **Use the power tool, accessories and tool bits etc. in accordance with these instructions, taking into account the working conditions and the work to be performed.** *Use of the power tool for operations different from those intended could result in a hazardous situation.*
- h. **Keep handles and grasping surfaces dry, clean and free from oil and grease.** *Slippery handles and grasping surfaces do not allow for safe handling and control of the tool in unexpected situations.*

5. Battery Tool Use And Care

- a. **Recharge only with the charger specified by the manufacturer.** *A charger that is suitable for one type of battery pack may create a risk of fire when used with another battery pack.*
 - b. **Use power tools only with specifically designated battery packs.** *Use of any other battery packs may create a risk of injury and fire.*
 - c. **When battery pack is not in use, keep it away from other metal objects such as paper clips, coins, keys, nails, screws or other small metal objects that can make a connection from one terminal to another.** *Shorting the battery terminals together may cause burns or a fire.*
 - d. **Under abusive conditions, liquid may be ejected from the battery; avoid contact.** *If contact accidentally occurs, flush with water. If liquid contacts eyes, seek additional medical help. Liquid ejected from the battery may cause irritation or burns.*
 - e. **Do not use a battery pack or tool that is damaged or modified.** *Damaged or modified batteries may exhibit unpredictable behavior resulting in fire, explosion or risk of injury.*
 - f. **Do not expose a battery pack or tool to fire or excessive temperature.** *Exposure to fire or temperature above 212°F (100°C) may cause explosion.*
 - g. **Follow all charging instructions and do not charge the battery pack or tool outside the temperature range specified in the instructions.** *Charging improperly or at temperatures outside the specified range may damage the battery and increase the risk of fire.*
- #### 6. Service
- a. **Have your power tool serviced by a qualified repair person using only identical replacement parts.** *This will ensure that the safety of the power tool is maintained.*
 - b. **Never service damaged battery packs.** *Service of battery packs should only be performed by the manufacturer or authorized service providers.*



WARNING!

Use only with SENIX X2 batteries: B20X2 / B25X2 / B40X2 / B50X2.

SAFETY INSTRUCTIONS FOR JIG SAWS

- a. **Hold the power tool by insulated gripping surfaces when performing an operation where the cutting accessory may contact hidden wiring.** *Cutting accessory contacting a "live" wire may make exposed metal parts of the power tool "live" and could give the operator an electric shock*
- b. **Use clamps or another practical way to secure and support the workpiece to a stable platform.** *Holding the workpiece by hand or against your body leaves it unstable and may lead to loss of control.*

EMERGENCY

Familiarize yourself with the use of this product by means of this instruction manual. Memorize the safety directions and follow them to the letter. This will help to prevent risks and hazards.

1. Always be alert when using this product so that you can recognize and handle risks early. Fast intervention can prevent serious injury and damage to property.
2. Switch off and disconnect from the power supply if there are malfunctions. Have the product checked by a qualified professional and repaired, if necessary, before you operate it again.

RESIDUAL RISKS

Even if you are operating this product in accordance with all the safety requirements, potential risks of injury and damage remain. The following dangers can arise in connection with the structure and design of this product:

1. Health defects resulting from vibration emission if the product is being used over long periods of time or not adequately managed and properly maintained.
2. Injuries and damage to property due to broken cutting attachments or the sudden impact of hidden objects during use.
3. Danger of injury and property damage caused by flying objects.
4. Prolonged use of this product expose the operator to vibrations and may produce 'whitefinger' disease. In order to reduce the risk, please wear gloves and keep your hands warm. If any of the 'whitefinger' symptoms appear, seek medical advice immediately. 'Whitefinger' symptoms

include: numbness, loss of feeling, tingling, pricking, pain, loss of strength, changes in skin colour or condition. These symptoms normally appear in the fingers, hands or wrists. The risk increases at low temperatures.



WARNING!

This product produces an electromagnetic field during operation! This field may under some circumstances interfere with active or passive medical implants! To reduce the risk of serious or fatal injury, we recommend persons with medical implants to consult their doctor and the medical implant manufacturer before operating this product!

SAVE THESE INSTRUCTIONS

INTENDED USE

The product is intended for sawing wood, metal and plastic. It is suitable for cutting in straight and curved lines.

KNOW YOUR UNIT

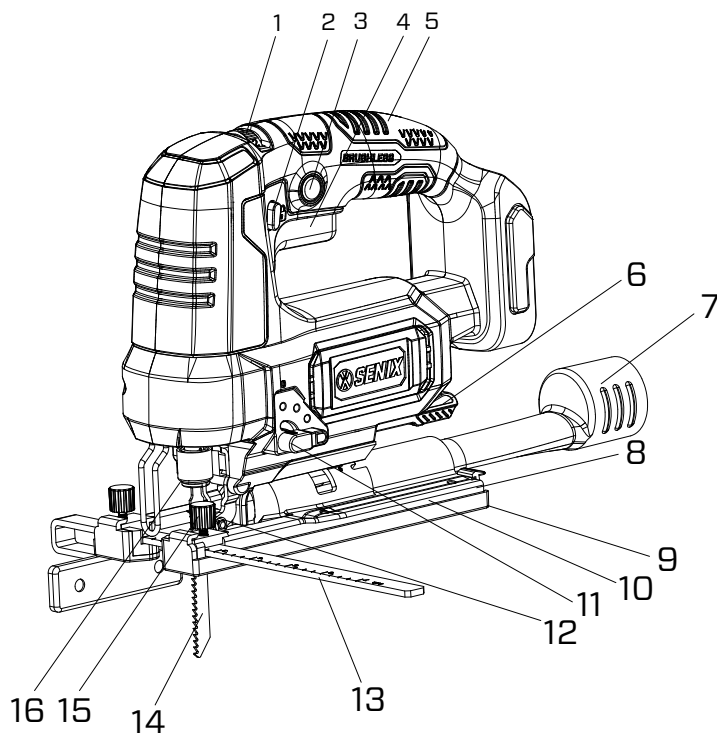

APPLICATIONS

Model: PSJX2-M3-EU

As a jig saw:

sawing wood, metal and plastic.

1	Speed Adjustment Dial
2	Safety Switch
3	Lock-On Button
4	Variable Speed Trigger
5	Handle
6	Bevel Adjustment Lever
7	Dust Extraction Tube
8	Wrench Storage

9	No-Mar Shoe Cover
10	Base Plate
11	Orbital Action Selector
12	Roller Guide
13	Rip Fence
14	Saw Blade
15	Rip Fence Adjustment Knob
16	Saw Blade Chuck

SPECIFICATIONS

Model	PSJX2-M3-EU
Voltage	18 V \approx (20 V \approx Max*)
Motor Type	Brushless
Stroke Length	7/8"
No-Load Speed	0 - 3 000 SPM
Bevel Capacity	0-45°
Orbital Action Settings	4-Position: 0/1/2/3
Cutting Capacity	Wood: 5-5/16" Steel : 3/8"
Blade Style	T-Shank
Weight (Tool Only)	4.1 lbs (1.85 kg)

*20V Max battery, maximum initial battery voltage (measured without a workload) is 20V. The nominal voltage is 18V.

ASSEMBLY

1. Unpack all components and lay them on a flat, stable surface:
2. Remove all packing materials and shipping devices, if applicable.
3. The scope of delivery varies depending on the country and purchased variant.
 - Cordless jig saw x1
 - Rip Fence x1
 - Hex wrench x1
 - Saw blade x1
 - Dust extraction tube x1
 - No-mar shoe cover x1
 - Instruction manual x1
4. If you find that parts are missing or show damage, do not use the product and contact your dealer. Using an incomplete or damaged product represents a hazard to people and property.
5. Ensure that you have all the accessories and tools needed for assembly and operation. This also includes suitable personal protective equipment.



WARNING!



Wear protective gloves for this assembly work and always lay the product on a flat and stable surface while assembling.



Follow the assembly instructions step-by-step and use the pictures provided as a visual guide to easily assemble the product!
Do not insert the battery pack before the power tool is completely assembled or adjusted!

INSTALLING THE RIP FENCE

Insert the rip fence into the guide holes on the side of the base with the fence facing down. Slide the rip fence to the desired cutting width and secure it in place by tightening the rip fence adjustment knob.

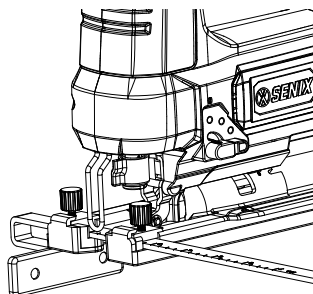

Fig. 1

INSTALLING/REMOVING THE DUST EXTRACTION TUBE

- 1. Insert the dust extraction tube all the way into the vacuum port.
- 2. To remove, pull the dust extraction tube away from product.

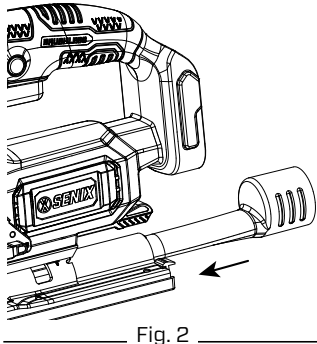

Fig. 2

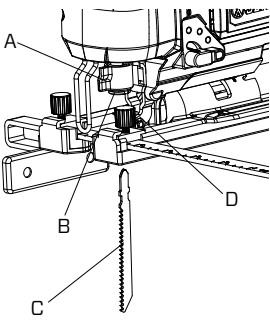

Fig. 3

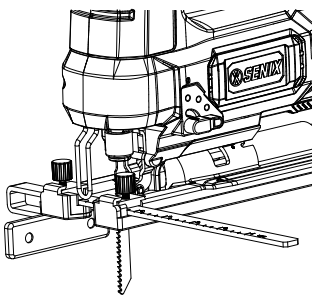

Fig. 4



WARNING!

Never operate the saw with a bent, damaged or loose blade.

INSTALLING/REMOVING THE SAW BLADE

- 1. Clean the shank on the saw blade before inserting it. A dirty shank cannot be securely fixed in place.
- 2. Insert the saw blade into the chuck until it produces a "click" sound and locks securely into place. The blade release lever will automatically turn 90° clockwise when the blade is secure.
- 3. Ensure that the saw teeth are facing away from the tool and that the back of the saw blade is seated in the groove on the roller guide.
- 4. Check that the saw blade is secure in the chuck by pulling it away from the tool. A loose saw blade can fall out during use and lead to injury.
- 5. Turn the blade clamp lever 90° counterclockwise to eject the saw blade. The chuck will remain open until a new blade is inserted.

A	Blade Clamp Lever
B	Saw Blade Chuck
C	Saw Blade
D	Roller Guide

INSTALLING/REMOVING THE BATTERY PACK

To install:

Align and slide the battery pack onto the slots of the battery docking port until it locks in place.

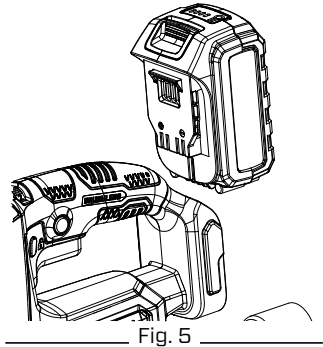

To remove:

Press the battery-release button and remove the battery pack from the product.

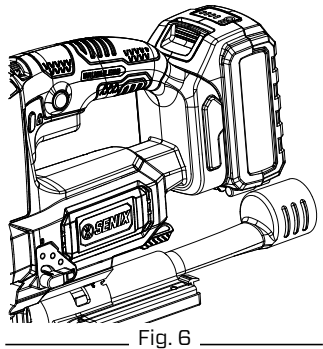

i NOTE:

Refer to the manuals for the charger and battery pack for more details.

OPERATION

! WARNING!

Inspect the tool for complete installation. Operating with any missing or damaged parts or accessories can result in serious injury.

SWITCHING ON/OFF

1. To start, push the safety switch then pull the variable speed trigger. Tool accelerates when increasing pressure on the trigger.
2. For continuous operation, pull the trigger, and then push in the lock-on button. To stop the tool, pull the trigger fully, and then release it.

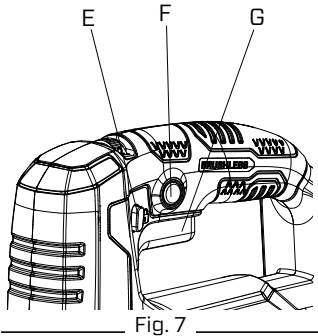

E	Safety Switch
F	Lock-On Button
G	Variable Speed Trigger

SETTING THE ORBITAL ACTION

This tool can be operated with an orbital or a straight vertical cutting action. The orbital cutting action thrusts the jig saw blade forward on the cutting stroke and greatly increases cutting speed.

To change the orbital action, just turn the orbital action selector to the desired position. Refer to the table to select the appropriate cutting action.

Position	Cutting Action	Applications
0	Straight Vertical	Cutting mild steel, stainless steel and plastics
		Clean cuts in wood and plywood
1	Low Orbital	Cutting mild steel, aluminum and hard wood.
2	Medium Orbital	Cutting wood and plywood
		Fast cutting in aluminum and mild steel
3	High Orbital	Fast cutting in wood and plywood

SETTING THE SPEED

The tool speed can be adjusted by turning the speed adjustment dial between the lowest (1) and highest settings (6).

Refer to the table below to select the proper speed for the material to be cut. However, the appropriate speed may differ with the type or thickness of the workpiece. In general, higher speeds will allow you to cut faster but will result in a reduced service life of the jig saw blade.

Workpiece Material	Speed Setting
Wood	4-6
Mild Steel	4-6
Stainless Steel	4-5
Aluminum	4-6
Plastics	1-5



NOTE:

There is also an intermediate speed setting between each numbered position on the speed adjustment dial.

WORK LIGHT

This tool is designed with a LED work light for working in dim areas. It lights up when the trigger is pulled and goes out automatically after the trigger is released.

BEVEL CUTTING



WARNING!

Always switch off the tool and remove the battery pack before adjusting the angle of the base plate.

This tool is capable of making bevel cuts at any angle between 0° and 45° (left or right).

1. Loosen the bevel adjustment lever.
2. Pull the base forward slightly until the detents are not engaged.
3. Tilt the base to a desired angle (0°, 15°, 30°, or 45°) and push the base into the detent.
4. Tighten the bevel adjustment lever.

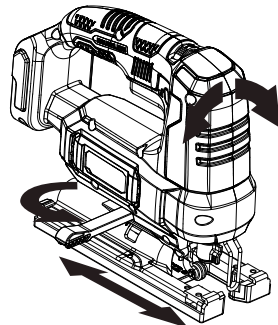

Fig. 8

USING THE HEX WRENCH

If the base does not appear secure after fully tightening the bevel adjustment lever, use the included hex wrench to tighten the adjustment screw.

Remove the no-mar shoe cover, turn the tool over, and securely tighten the screw. When not in use, store the hex wrench as shown in the figure below to keep it from being lost.

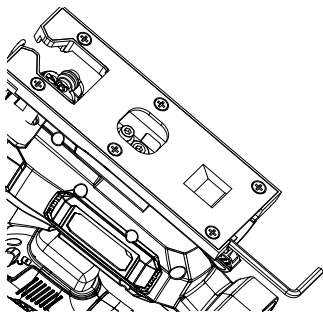

Fig. 9

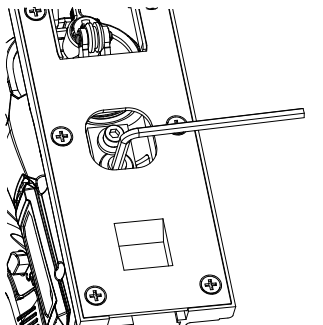

Fig. 10

USING THE NO-MAR SHOE COVER

Use the no-mar shoe cover when cutting decorative veneers, plastics, etc. It protects sensitive or delicate surfaces from damage. Attach it to the front edge of the base plate before securing it to the rear edge.

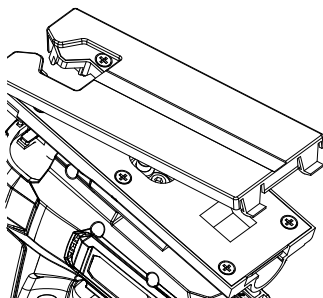

Fig. 11

GENERAL OPERATION



WARNING!

Always hold the base flush with the workpiece. Failure to do so may cause jig saw blade breakage, resulting in a serious injury.



WARNING!

Advance the tool very slowly when cutting curves or scrolling. Forcing the tool may cause a slanted cutting surface and jig saw blade breakage.

Take the cutting channel into consideration when cutting along marked cutting lines. Cut next to line rather than directly on it.

It is recommended to make a trial cut before working on the actual workpiece to determine the position and width of the cutting channel, especially after replacing the blade or changing bevel angle.

Switch the product off, let it come to a complete stop and remove battery pack if the saw blade gets stuck in the workpiece. Only then free the jammed blade.

1. Cut in the direction of the wood grain whenever possible to avoid jamming the saw blade and fraying edges.
2. Always add cooling liquid along the cutting line to reduce heat when cutting metal.
3. Ensure that there is sufficient clearance for the saw blade under the workpiece.
4. Hold the product with one hand on the handle, and with the other hand on the front grip area..
5. Switch the product on and wait until it reaches full speed before placing it on the workpiece.
6. Carefully lead the product toward the workpiece. Place the base plate flat on the workpiece and push the product at an even speed.
7. Only apply as much forward and vertical pressure as necessary to keep the product flat on the workpiece. Higher pressure will remove lower the performance of the product and leads to uneven results.
8. Keep the product moving at all times, do not stop in one position to avoid grooves.
9. Lift the product from the workpiece before switching it off.

OVERHEAT PROTECTION

The tool will automatically stop when either it or the battery overheats. If this occurs, allow the tool/battery to cool before resuming use.

MAINTENANCE



WARNING!

Only perform cleaning and maintenance according to these instructions! Any additional work must be performed by a qualified specialist!



WARNING!

TO PREVENT SERIOUS INJURY FROM ACCIDENTAL OPERATION: Make sure the battery pack is removed before performing any procedure in this section.

TO PREVENT SERIOUS INJURY FROM TOOL FAILURE: Do not use damaged equipments. If abnormal noise or vibration occurs, have the problem corrected before further use.

There are no user-serviceable parts in your power tool. If any of following condition are found, stop using it and send it to the authorized service center for repair.

- Leaking, swollen, or cracked battery pack
- Loose hardware
- Misalignment or binding of accessories.
- Cracked or broken parts.
- Any other condition that may affect its safe operation.

CLEANING

- Clean dust from air vents.
- Keep handles clean, dry and free of oil or grease.
- Make sure the roller guide and the saw blade chuck are not clogged by debris.
- Remove stubborn dirt from housing with high pressure air (max. 3 bar) or a cloth.
- Never immerse your tool in liquid or allow a liquid to flow inside them.



WARNING!

Do not use chemical, alkaline, abrasive or other aggressive detergents or disinfectants to clean this product as they might be harmful to its surfaces.

TRANSPORTATION

- Always carry the product by its handle.
- Secure the product properly when transporting.

STORAGE

- Store the product and its accessories in a dark, dry, frost-free, well-ventilated place.
- Store the tool separately from the battery pack.
- The recommended storage temperature for tools and the batteries is 50°F - 86°F (10°C - 30°C).
- Use original package for storage or cover with a suitable cloth to protect against dust.

DISPOSAL

When the jig saw is no longer usable, do not dispose of it with household waste. It must be recycled at a proper facility.



Electrical products should not be discarded with household products. Used electrical products must be collected separately and disposed of at collection points provided for this purpose. Talk with local authorities or dealer for advice on recycling.

TROUBLESHOOTING

Suspected malfunctions are often due to causes that users can fix themselves. Therefore, troubleshoot the product using this section. In most cases the problem can be solved quickly.

Problem	Possible Cause	Solution
Product does not start	Battery pack not properly attached	Attach properly
	Battery pack discharged	Remove and charge battery pack
Product does not reach full power	Battery pack capacity too low	Charge the battery pack
	Battery pack reaches its life cycle	Replace with new one
	The product has exceeded safe operating temperature	Clear all air vents and allow the product to cool
Vibration or excessive noise	Unknown - stop operating the saw to prevent additional damage	Contact an Authorized Service Center for repair
Unsatisfactory result	Dull saw blade	Replace with a new one
	Cutting action is not suitable for current application	Set the orbital action to a more appropriate position for the current application

WARRANTY

SENIX TOOLS LIMITED WARRANTY

FOR FIVE YEARS from the date of original purchase this product is warranted against defects in material or workmanship. WITH PROOF OF ORIGINAL PURCHASE a defective product will receive free repair. If the product cannot be repaired it will be replaced free of charge.

For details to obtain warranty coverage, visit senixtools.com, email senix.support@yatusa.com or call **1-800-261-3981**.

- This warranty does not cover repairs necessary due to product accident or abuse, or failure to operate or maintain the product according to all supplied instructions.
- This warranty does not cover an included battery pack or charger, which offer three-year, replacement-only coverage. See battery pack or charger instruction manuals for complete warranty details.
- This warranty does not cover expendable items that can wear out from normal use within the warranty period, including but not limited to drill bits, cutting blades and trimmer spool or line.
- This warranty does not apply to damage resulting from repairs to the product made or attempted by other than SENIX authorized agents.
- This warranty does not cover the cost of mailing or transporting the power tool to receive warranty coverage.
- The warranty is void if the product has been used for commercial, professional, or rental service purposes.
- The warranty applies to the original retail purchaser and is not transferable.
- Proof of purchase is required to obtain warranty coverage.

THIS WARRANTY IS GIVEN IN LIEU OF ALL OTHERS, INCLUDING THE IMPLIED WARRANTY OF MERCHANTABILITY AND FITNESS FOR A PARTICULAR PURPOSE, AND EXCLUDES ALL INCIDENTAL OR CONSEQUENTIAL DAMAGE.

Some states do not allow limitations on how long an implied warranty lasts or the exclusion or limitation of incidental or consequential damages, so these limitations may not apply to you. This warranty gives you specific legal rights and you may have other rights which vary in certain states or provinces.

NOTE: Battery pack warranty voided if the battery pack is tampered with in any way. SENIX is not responsible for any injury caused by tampering and may prosecute warranty fraud to the fullest extent permitted by law.

60-DAY MONEY-BACK GUARANTEE. If for any reason within 60 days from the date of original purchase you are not completely satisfied with the performance of this SENIX product, you can return it with the original sales receipt for a full refund.

Latin America: This warranty does not apply to products sold in Latin America. For products sold in Latin America, see the country-specific warranty information contained in the packaging, call the retailer from which it was purchased, or visit the website for warranty information.

Free warning label replacement: If your warning labels become illegible or are missing, call **1-800-261-3981** for a free replacement.

REGISTER ONLINE - senixtools.com/pages/product-registration

Thank you for your purchase! Register your product now for:

Warranty Service: Registering your product will help you obtain more efficient warranty service in case of a problem with your product.

Confirmation of Ownership: In case of an insurance loss, such as fire, flood, or theft, your ownership registration will serve as proof of purchase.

For your safety: Registering your product will allow us to contact you in the unlikely event a safety notification is required under the Federal Consumer Safety Act.



YAT USA INC. 10506 Bryton Corporate Center Dr, #500 Huntersville, NC 28078

For customer support, please call **1-800-261-3981** or email us at senix.support@yatusa.com