

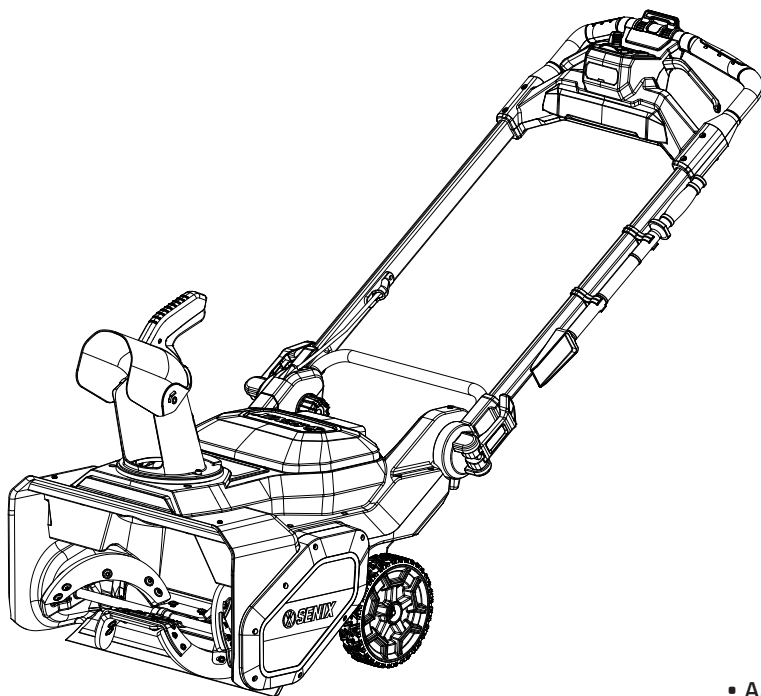

X6 **60V** **||||** **BRUSHLESS**TM
LITHIUM-ION

21" CORDLESS SINGLE STAGE SNOW BLOWER



CAUTION: Before using this tool, please read this manual completely, and follow all operating safety measures.

- SAFETY
- ASSEMBLY
- OPERATION
- MAINTENANCE
- WARRANTY

YAT USA INC. 10506 Bryton Corporate Center Dr, #500 Huntersville, NC 28078
For customer support, please call 1-800-261-3981 or email us at senix.support@yatusa.com

TABLE OF CONTENTS

SAFETY & INTERNATIONAL SYMBOLS.....	2
SAFETY INSTRUCTIONS.....	3
KNOW YOUR UNIT.....	7
SPECIFICATIONS.....	8
ASSEMBLY.....	8
OPERATION.....	10
MAINTENANCE.....	14
TROUBLESHOOTING.....	18
WARRANTY.....	20

SAFETY & INTERNATIONAL SYMBOLS

The following table depicts and describes safety and international symbols and pictographs that may appear on this product. Read, understand, and follow all instructions on the machine and in the instruction manual for complete safety, assembly, operating, maintenance, and repair information before attempting to assemble and operate.



WARNING - To reduce the risk of injury, user must read instruction manual.



SAFETY ALERT - Indicates a precaution, a warning or a danger.



Wear hearing protection. Wear eye protection. Wear breathing protection.



Keep hands, feet and clothing away from the rotating auger to avoid injury.



Wear protective gloves and non-slip footwear when using the machine and handling debris.



Keep the flexible power supply cord away from the cutting blades.



WARNING! Do not expose the unit to rain.



DANGER! Cutting/dismemberment hazard - Keep feet away from the rotating auger.



CAUTION! Beware of stones and other foreign objects that could be thrown from the equipment.



WARNING: Disconnect battery before maintenance.



Keep bystanders and children a safe distance (at least 11 yd/10 m) away from the work area.



The rotating part will continuously run for several seconds after you turn off the machine.



Waste electrical products should not be disposed of with household waste. Please recycle where facilities exist. Check with your Local Authority or local store for recycling advice.



Complies with UL standards

SAFETY INSTRUCTIONS

GENERAL POWER EQUIPMENT SAFETY WARNINGS



WARNING!

Read all safety warnings, instructions, illustrations and specifications, provided with this power equipment. Failure to follow all instructions listed below may result in electric shock, fire and/or serious injury. Save all warnings and instructions for future reference.

The term “power equipment” in the warnings refers to your mains-operated (corded) power equipment or battery-operated (cordless) power equipment.

1. Work Area Safety

- a. **Keep work area clean and well lit.**
Cluttered or dark areas invite accidents.
- b. **Do not operate power equipment in explosive atmospheres, such as in the presence of flammable liquids, gases or dust.**
Power equipment create sparks which may ignite the dust or fumes.
- c. **Keep children and bystanders away while operating a power equipment.**
Distractions can cause you to lose control.

2. Electrical Safety

- a. **Power equipment plugs must match the outlet. Never modify the plug in any way. Do not use any adapter plugs with earthed (grounded) power equipment.**
Unmodified plugs and matching outlets will reduce risk of electric shock.
- b. **Avoid body contact with earthed or grounded surfaces, such as pipes, radiators, ranges and refrigerators.**
There is an increased risk of electric shock if your body is earthed or grounded.
- c. **Do not expose power equipment to rain or wet conditions.**
Water entering a power equipment will increase the risk of electric shock.
- d. **Do not abuse the cord. Never use the cord for carrying, pulling or unplugging the power equipment. Keep cord away from heat, oil, sharp edges or moving parts.**
Damaged or entangled cords increase the risk of electric shock.

- e. **When operating a power equipment outdoors, use an extension cord suitable for outdoor use.**
Use of a cord suitable for outdoor use reduces the risk of electric shock.
- f. **If operating a power equipment in a damp location is unavoidable, use a ground fault circuit interrupter (GFCI) protected supply.**
Use of a GFCI reduces the risk of electric shock.

3. Personal Safety

- a. **Stay alert, watch what you are doing and use common sense when operating a power equipment. Do not use a power equipment while you are tired or under the influence of drugs, alcohol or medication.**
A moment of inattention while operating power equipment may result in serious personal injury.
- b. **Use personal protective equipment. Always wear eye protection.**
Protective equipment such as a dust mask, non-skid safety shoes, hard hat or hearing protection used for appropriate conditions will reduce personal injuries.
- c. **Prevent unintentional starting. Ensure the switch is in the off-position before connecting to power source and/or battery pack, picking up or carrying the equipment.**
Carrying power equipment with your finger on the switch or energizing power equipment that have the switch on invites accidents.
- d. **Remove any adjusting key or wrench before turning the power equipment on.**
A wrench or a key left attached to a rotating part of the power equipment may result in personal injury.
- e. **Do not overreach. Keep proper footing and balance at all times.**
This enables better control of the power equipment in unexpected situations.
- f. **Dress properly. Do not wear loose clothing or jewelry. Keep your hair, clothing and gloves away from moving parts.**
Loose clothes, jewelry or long hair can be caught in moving parts.
- g. **If devices are provided for the connection of dust extraction and collection facilities, ensure these are connected and properly used.**
Use of dust collection can reduce dust-related hazards.
- h. **Do not let familiarity gained from frequent use of equipment allow you to become complacent and ignore**

equipment safety principles. *A careless action can cause severe injury within a fraction of a second.*

4. Power Equipment Use and Care

- a. **Do not force the power equipment. Use the correct power equipment for your application.** *The correct power equipment will do the job better and safer at the rate for which it was designed.*
- b. **Do not use the power equipment if the switch does not turn it on and off.** *Any power equipment that cannot be controlled with the switch is dangerous and must be repaired.*
- c. **Disconnect the plug from the power source and/or remove the battery pack, if detachable, from the power equipment before making any adjustments, changing accessories, or storing power equipment.** *Such preventive safety measures reduce the risk of starting the power equipment accidentally.*
- d. **Store idle power equipment out of the reach of children and do not allow persons unfamiliar with the power equipment or these instructions to operate the power equipment.** *Power equipment are dangerous in the hands of untrained users.*
- e. **Maintain power equipment and accessories. Check for misalignment or binding of moving parts, breakage of parts and any other condition that may affect the power equipment's operation. If damaged, have the power equipment repaired before use.** *Many accidents are caused by poorly maintained power equipment.*
- f. **Keep cutting equipment sharp and clean.** *Properly maintained cutting equipment with sharp cutting edges are less likely to bind and are easier to control.*
- g. **Use the power equipment, accessories and equipment bits etc. in accordance with these instructions, taking into account the working conditions and the work to be performed.** *Use of the power equipment for operations different from those intended could result in a hazardous situation.*
- h. **Keep handles and grasping surfaces dry, clean and free from oil and grease.** *Slippery handles and grasping surfaces do not allow for safe handling and control of*

the equipment in unexpected situations.

5. Battery Equipment Use and Care

- a. **Recharge only with the charger specified by the manufacturer.** *A charger that is suitable for one type of battery pack may create a risk of fire when used with another battery pack.*
- b. **Use power equipment only with specifically designated battery packs.** *Use of any other battery packs may create a risk of injury and fire.*
- c. **When battery pack is not in use, keep it away from other metal objects, like paper clips, coins, keys, nails, screws or other small metal objects, that can make a connection from one terminal to another.** *Shorting the battery terminals together may cause burns or a fire.*
- d. **Under abusive conditions, liquid may be ejected from the battery; avoid contact.** *If contact accidentally occurs, flush with water. If liquid contacts eyes, additionally seek medical help. Liquid ejected from the battery may cause irritation or burns.*
- e. **Do not use a battery pack or equipment that is damaged or modified.** *Damaged or modified batteries may exhibit unpredictable behavior resulting in fire, explosion or risk of injury.*
- f. **Do not expose a battery pack or equipment to fire or excessive temperature.** *Exposure to fire or temperature above 265 °F (130 °C) may cause explosion.*
- g. **Follow all charging instructions and do not charge the battery pack or equipment outside the temperature range specified in the instructions.** *Charging improperly or at temperatures outside the specified range may damage the battery and increase the risk of fire.*

6. Service

- a. **Have your power equipment serviced by a qualified repair person using only identical replacement parts.** *This will ensure that the safety of the power equipment is maintained.*
- b. **Never service damaged battery packs.** *Service of battery packs should only be performed by the manufacturer or authorized service providers.*

GENERAL REQUIREMENTS FOR BATTERY-POWERED EQUIPMENT

- a. Prevent unintentional starting. Ensure the switch is in the off-position before connecting to battery pack, picking up or carrying the equipment. Carrying the appliance with your finger on the switch or energizing equipment that have the switch on invites accidents.
- b. Disconnect the battery pack from the appliance before making any adjustments, changing accessories, or storing equipment. Such preventive safety measures reduce the risk of starting the appliance accidentally.
- c. Recharge only with the charger specified by the manufacturer. A charger that is suitable for one type of battery pack may create a risk of fire when used with another battery pack.
- d. Use equipment only with specifically designated battery packs. Use of any other battery packs may create a risk of injury and fire.
- e. When battery pack is not in use, keep it away from other metal objects, like paper clips, coins, keys, nails, screws or other small metal objects, that can make a connection from one terminal to another. Shorting the battery terminals together may cause burns or a fire.
- f. Under abusive conditions, liquid may be ejected from the battery; avoid contact. If contact accidentally occurs, flush with water. If liquid contacts eyes, additionally seek medical help. Liquid ejected from the battery may cause irritation or burns. (This advice is considered correct for conventional NiMH, NiCd, lead acid and lithium-ion cell types. If this advice is incorrect for a cell design that differs from these, then the correct advice may be substituted.)
- g. Do not use a battery pack or equipment that is damaged or modified. Damaged or modified batteries may exhibit unpredictable behavior resulting in fire, explosion or risk of injury.
- h. Do not expose a battery pack or equipment to fire or excessive temperature. Exposure to fire or temperature above 130°C may cause explosion. The temperature of

130°C can be replaced by the temperature of 265°F.

- i. Follow all charging instructions and do not charge the battery pack or appliance outside of the temperature range specified in the instructions. Charging improperly or at temperatures outside of the specified range may damage the battery and increase the risk of fire.
- j. Have servicing performed by a qualified repair person using only identical replacement parts. This will ensure that the safety of the product is maintained.
- k. Do not modify or attempt to repair the equipment or the battery pack (as applicable) except as indicated in the instructions for use and care.

SAFE OPERATION PRACTICES FOR SINGLE STAGES SNOW BLOWER

General

This machine is capable of amputating hands and feet and throwing objects. Failure to observe the following safety instructions could result in serious injury.

Training

- a. Read, understand and follow all instructions on the machine and in the manual(s) before operating this unit. Be thoroughly familiar with the controls and the proper use of the machine. Know how to stop the unit and disengage the controls quickly.
- b. Never allow children to operate the machine. Never allow adults to operate the machine without proper instruction.
- c. Keep the area of operation clear of all persons, particularly small children.
- d. Exercise caution to avoid slipping or falling, especially when operating the machine in reverse.

Preparation

- a. Thoroughly inspect the area where the machine is to be used and remove all doormats, sleds, boards, wires and other foreign objects.
- b. Do not operate the machine without wearing adequate winter garments. Avoid loose fitting clothing that can get caught

- in moving parts. Wear footwear that will improve footing on slippery surfaces.
- c. Do not operate the equipment without wearing adequate winter garments. Avoid loose fitting clothing that can get caught in moving parts. Wear footwear that will improve footing on slippery surfaces.
 - d. Adjust the collector housing height to clear gravel.
 - e. Never attempt to make any adjustments while the motor is running (except when specifically recommended by manufacturer).
 - f. Always wear safety glasses or eye shields during operation or while performing an adjustment or repair to protect eyes from foreign objects that may be thrown from the machine.

Operation

- a. Do not put hands or feet near or under rotating parts. Keep clear of the discharge opening at all times.
- b. Exercise extreme caution when operating on or crossing gravel drives or walks. Stay alert for hidden hazards or operating near public roads.
- c. After striking a foreign object, stop the motor, remove the battery, thoroughly inspect the snow thrower for any damage, and repair the damage before restarting and operating the snow blower.
- d. If the machine should start to vibrate abnormally, stop the motor and check immediately for the cause. Vibration is generally a warning of trouble.
- e. Stop the motor whenever you leave the operating position, before unclogging the collector/impeller housing or discharge chute, and when making any repairs, adjustments or inspections.
- f. Exercise extreme caution when operating on slopes.
- g. Never operate the machine without proper guards and other safety protective devices in place and working.
- h. Never direct the discharge toward people or areas where property damage can occur. Keep children and others away.
- i. Do not overload the machine capacity by attempting to clear snow at too fast a rate.
- j. Never operate the machine at high transport speeds on slippery surfaces. Look behind and use care when operating in reverse.
- k. Disengage power to the collector/impeller when the machine is transported or not in use.

- l. Use only attachments and accessories approved by the manufacturer of the machine (such as wheel weights, counterweights or cabs).
- m. Never operate the machine without good visibility or light. Always be sure of your footing, and keep a firm hold on the handles. Walk; never run.

Clearing a clogged discharge chute

- a. Hand contact with the rotating impeller inside the discharge chute is the most common cause of injury associated with snow throwers. Never use your hand to clean out the discharge chute.
- b. To clear the chute:
 - 1. SHUT THE MOTOR OFF!
 - 2. Wait 10 s to be sure the auger has stopped rotating
 - 3. Disconnect the battery before cleaning or inspecting the auger.
 - 4. Always use a clean-out tool, not your hands.

Maintenance and storage

- a. Check shear bolts and other bolts at frequent intervals for proper tightness to be sure the equipment is in safe working condition.
- b. Always refer to instruction handbook for important details if the snow thrower is to be stored for an extended period.
- c. Maintain or replace safety labels, as necessary.
- d. Run the machine a few minutes after throwing snow to prevent freeze-up of the collector/impeller.

SAVE THESE INSTRUCTIONS

INTENDED USE

This cordless snow shovel is intended for removing and clearing away snow from sidewalks, decks, driveways and other flat paved surfaces. Do not use it for other purposes.

KNOW YOUR UNIT

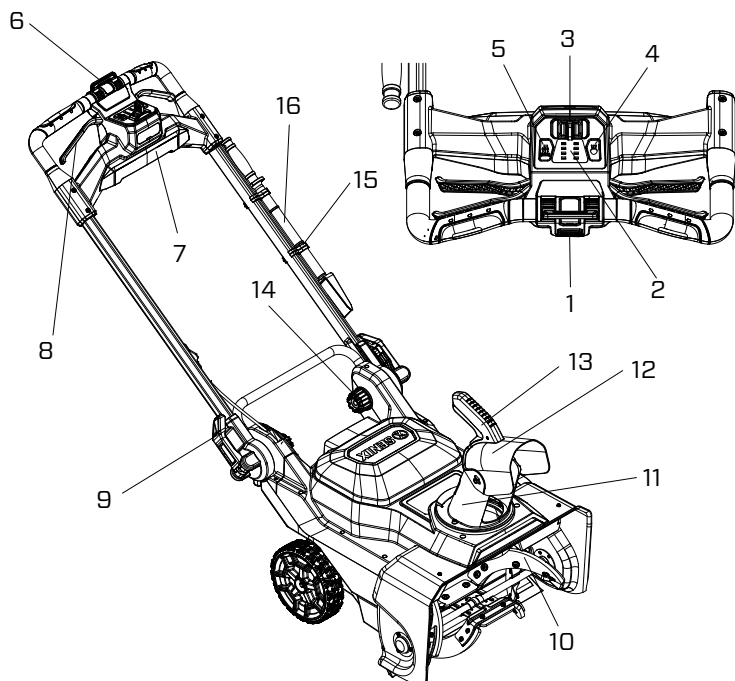

APPLICATIONS

Model: STX6-H

As a cordless snow blower:
Removing and clearing away snow from paved surfaces.

1	Safety Button
2	Charge Level Indicator
3	Chute-Rotation Lever (side to side)
4	LED ON/OFF Button
5	Heated Handles Button
6	Auger-Speed Dial
7	LED Headlights
8	Paddle Switch

9	Quick-Release Lever
10	Auger Assembly
11	Discharge Chute
12	Chute Deflector
13	Chute Deflector Handle
14	Lock Knob
15	Tool Clamp
16	Clean Out Tool

SPECIFICATIONS

Model	STX6-H
Voltage	56 V \equiv (60V \equiv Max*)
Rated Output Power	3500 W
No-Load Speed	1700-2200 RPM
Max. Clearing Width	21"
Max. Plow Depth	13"
Max. Throw Distance	45'
Max. Clearing Capacity	1200 lbs/min
Recommended Operating Temperature	-4°F-50°F (-20°C-10°C)
Recommended Storage Temperature	-4°F-158°F (-20°C-70°C)
Weight (Tool only)	52.8 lbs 24 kg

*60V Max battery, maximum initial battery voltage measured without a workload is 60V. The nominal voltage is 56V.



NOTE:

Use only SENIX X6 batteries B30X6, B40X6, B60X6, B80X6 and B120X6 and chargers CHX6-L, CHQX6, CHQX6-M and CHDX6-M.

ASSEMBLY

1. Unpack all parts and lay them on a flat, stable surface:
2. Remove all packing materials and shipping devices, if applicable.
3. The scope of delivery varies depending on the country and purchased variant.
 - Snow blower x1
 - Discharge chute x1
 - Hex Wrench x1
 - Instruction manual x1

4. If you find that parts are missing or show damage do not use the product but contact your dealer. Using an incomplete or damaged product represents a hazard to people and property.
5. Ensure that you have all the accessories and tools needed for assembly and operation. This also includes suitable personal protective equipment.



WARNING!



Wear protective gloves for this assembly work and always lay the product on a flat and stable surface while assembling. Follow the assembly instructions step-by-step and use the pictures provided as a visual guide to easily assemble the product! Do not insert the battery pack before the power tool is completely assembled or adjusted!



WARNING!

To avoid product damage or personal injury, the equipment should be assembled indoors at an ambient temperature above 23°F (-5°C). If any parts are damaged or missing, do not operate this product until the parts are replaced. Use of this product with damaged or missing parts could result in serious personal injury.



WARNING!

Do not attempt to modify this product or create accessories not recommended for use with this blower. Any such alteration or modification is misuse and could result in a hazardous condition leading to possible serious personal injury.



WARNING!

To prevent accidental starting that could cause serious personal injury, always remove the battery pack(s) from the tool when assembling parts.

UNFOLDING THE SIDE RAILS



WARNING!

Do not attempt to start the snow blower when the side rails are folded down.

1. Your snow blower is shipped with the side rails in the folded, locked position.

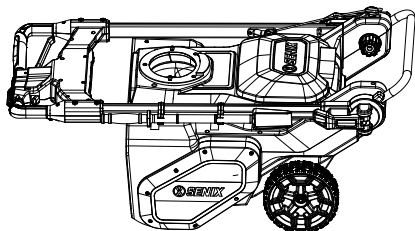

Fig. 1

2. Loosen the lock knobs as much as possible. Open the quick-release levers on both sides and gently pivot the side rails upwards until they come to a stop.

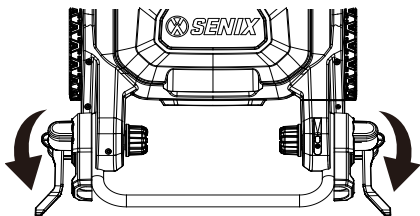

Fig. 2

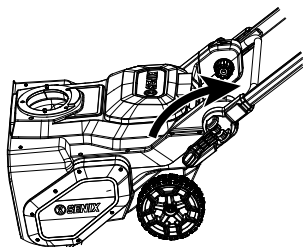

Fig. 3

3. Close the quick-release levers and then tighten the lock knobs to secure the side rails in place.

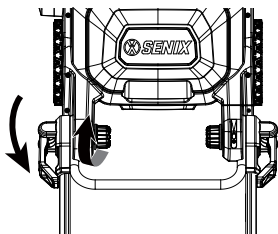

Fig. 4

INSTALLING THE CHUTE

1. Loosen and remove the two wing bolts from the chute base

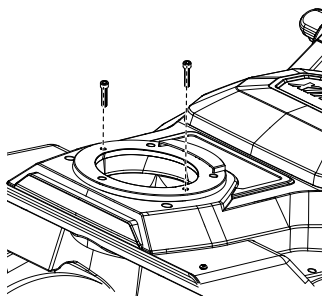

Fig. 5

2. Align the grooves of the chute with the slot on the chute base, and then push the chute in place.

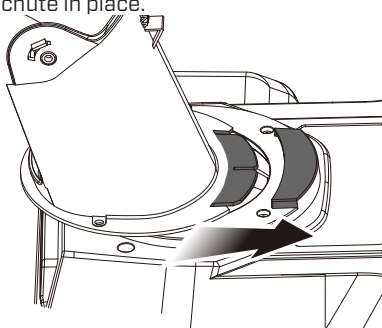

Fig. 6

3. Reinsert and tighten the wing bolts to secure the chute to the snow blower.

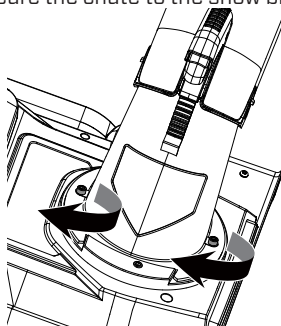

Fig. 7

WARNING!

Using the chute rotation handle located at the operator's position, make sure that the chute rotates properly with discharge opening never crossing operator controls.

WARNING!

Never operate the snow blower without the complete discharge chute in place.

OPERATION

WARNING!

Do not allow familiarity with this product to make you careless. Remember that a careless fraction of a second is sufficient to inflict serious injury.

WARNING!

Always wear eye protection marked to comply with ANSI Z87.1, along with hearing protection. Failure to do so could result in objects being thrown into your eyes and other possibly serious injuries.

WARNING!

Do not use any attachments or accessories not recommended by the manufacturer of this product. The use of attachments or accessories not recommended can result in serious personal injury.

ATTACHING/DETACHING BATTERY PACK

NOTE:

The snow blower can operate off of one or two batteries. Using two batteries gives you a longer run time and for best performance, we recommend use of two 6.0Ah or greater battery packs.

When not in use, SENIX X6 battery packs should be stored in an enclosed area within a temperature range of 50°F - 78.8°F (10°C - 26°C). Recommended charging temperature is between 32°F (0°C) and 104°F (40°C).

WARNING!

If any parts are broken or missing, do not attempt to attach the battery packs to the snow blower or operate the snow blower until the broken or missing parts are replaced. Failure to do so could result in serious injury.

WARNING!

Charge the battery pack before first use.

1. Raise the battery cover by lifting the front of the cover.
2. Align the grooves in the battery pack with the raised ribs in the battery compartment and then insert the battery pack into the compartment until you hear a "click".

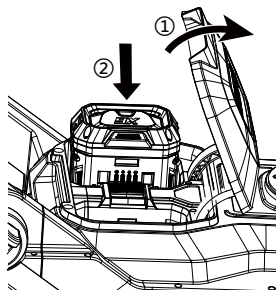

Fig. 8

3. To detach the battery pack, depress the battery-release button to release the battery pack, and then lift it out of the compartment.
4. Close the battery cover.

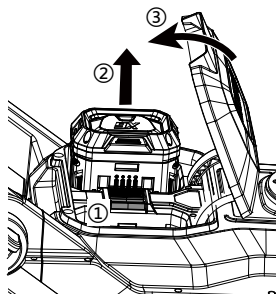

Fig. 9



NOTE:

If necessary, refer to the manuals for the charger and the battery pack for more details about how to charge the battery pack and other information.

STARTING/STOPPING THE SNOW BLOWER



WARNING!

Do not attempt to override the operation of the safety button and paddle switch.



WARNING!

The operation of a snow blower can result in foreign objects being thrown into your or others' eyes, which can damage eyes severely. Always wear safety glasses while operating the snow blower or while performing any adjustments or repairs on the snow blower.



WARNING!

The auger will continue to rotate for a few seconds after the snow blower is turned off. Allow the auger to stop rotating before starting it again.



NOTE:

Do not rapidly turn the snow blower off and on.

To Start the Snow Blower:

1. Ensure that the side rails are securely locked in the unfolded, open position.
2. Attach the battery pack(s) to the snow blower and close the battery cover. Refer to chapter "ATTACHING/DETACHING BATTERY PACK".
3. Power the snow blower ON by depressing the safety button.
4. With the safety button depressed, grasp the paddle switch upward to meet the main handle.

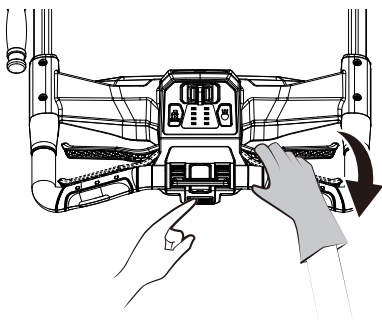

Fig. 10

5. Once the auger starts, release the safety button and begin operation.



NOTE:

The auger assembly can contact the ground during operation. The auger traction will assist in moving the snow blower forward.



NOTE:

The tool is started by depressing the safety button first, followed by squeezing the paddle switch. The reverse operation will not start the tool.



NOTE:

The snow blower may not properly start if its battery temperature is too low. If unit doesn't start, remove the battery from the snow blower and allow it to warm indoors for 10 minutes or longer. Reinstall the battery and try again.

To Stop the Snow Blower:

1. Fully release the paddle switch.
2. The electric brake in the Automatic Braking Mechanism will stop the auger rotation within 3 seconds of the paddle switch release.

VARIABLE-AUGER-SPEED SYSTEM

The speed of the auger determines the throwing distance. The speed of the auger is variable and can be adjusted using the auger-speed dial.

1. To increase the speed, move the auger-speed dial away from the operator.

2. To decrease the speed, move the auger-speed dial towards the operator.

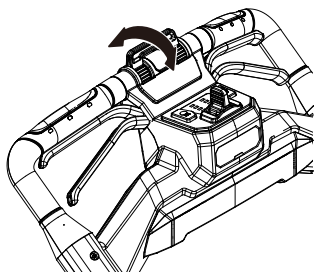

Fig. 11

ADJUSTING THE CHUTE

The chute can be adjusted to change both the direction and the distance of the discharged snow to assist you in moving snow away from one area and placing it in another.

Changing the direction:

The direction of snow removal can be adjusted up to 200°.

1. Push the chute-rotation lever left to rotate the chute to the left.
2. Pull the chute-rotation lever right to rotate the chute to the right.

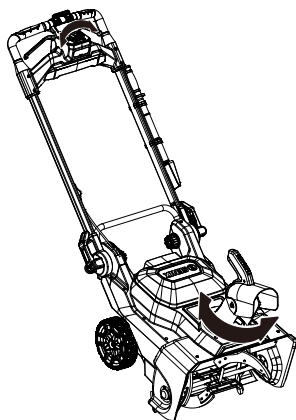

Fig. 12

Changing the distance:

The throwing distance of the snow blower is determined in part by the incline angle of the chute deflector.

WARNING!

Do not adjust the chute deflector while the switch trigger is engaged. Always release the switch trigger before adjusting the chute deflector.

1. To increase the distance that the snow thrown, squeeze the trigger on the chute deflector handle, and then raise the chute deflector. Release the trigger to lock the chute deflector in place.
2. To decrease the distance that the snow is thrown, simply lower the deflector with the chute-deflector handle.

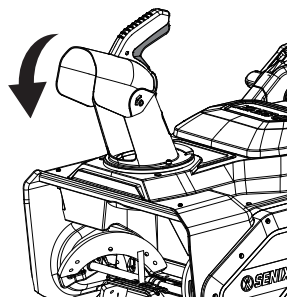

Fig. 13

WARNING!

Do not force the chute so far forward that a gap appears between the deflector and the chute itself. Snow or other debris could be thrown through the gap and back at the operator, resulting in serious personal injury.

HEATED GRIP

The handles have a heating feature to keep hands warm when working outside in the cold weather.

WARNING!

Ensure that the rubber coating is intact at the heated grip areas before turning the grip-heating on. Unprotected skin could suffer burn injury from contact with exposed heating elements.

1. Press the grip-heated handles button to heat the grip area. The button light will illuminate when the heating is turned on.
2. Press the grip-heated handles button again to turn off the heating. The button light will turn off.



NOTE:

When the heating is turned on, the temperature of the heated grip will be maintained between 95°F (35°C) and 131°F (55°C).



NOTE:

The heating will turn off automatically when the snow blower is inactive for 10 minutes to preserve the battery charge.

LED HEADLIGHTS

The LED headlights on the front of the housing and the main handle can illuminate the road for the machine in a dark area.

When the machine is powered on, the headlights will automatically light up. To turn off the lights, press the LED ON/OFF Button. To turn on the headlights, press the button again.

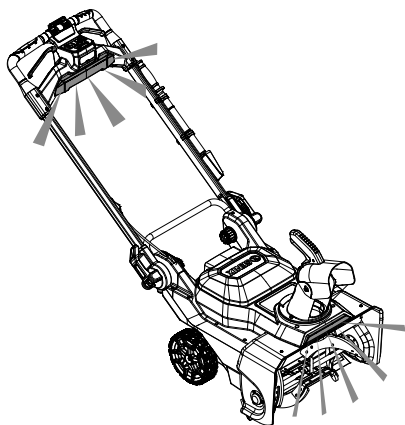

Fig. 14



NOTE:

There is no switch light to indicate whether the headlights are turned on or off.



NOTE:

The headlights will turn off automatically when the snow blower is inactive for 5s to preserve the battery charge.

CHARGE LEVEL INDICATOR ON THE SNOW BLOWER

The snow blower features a charge level indicator on the handle to communicate the charge level of the battery pack(s). The charge level indicator LEDs indicators will illuminate automatically when the snow blower is powered on.

SNOW BLOWER OVERLOAD PROTECTION

To prevent overload conditions, do not try to remove too much snow at one time. Slow down your pace or decrease the width of the snow-clearing swath.

Your snow blower has built-in overload-sensing elements. When the snow blower is overloaded, the motor will decrease the speed automatically and you will hear the noise level of the motor decrease. In case of overload, slow down your pace or narrow the clearing width, after which the motor speed will resume its normal setting automatically. Remove the battery pack(s) from the snow blower. Check to see if there is snow or ice stuck in the auger and deck and use a clean-out tool to clear them out as necessary. Reinstall the battery pack(s) and restart the snow blower.

OPERATING TIPS



WARNING!

Never use a snow blower on frozen lakes, rivers, or similar surfaces. Death or serious injury could occur if the ice breaks.



WARNING!

Never use the snow blower on a rooftop or other unstable surface, which can result in death or serious personal injury.



WARNING!

Do not use snow blower on ice, which can cause the operator to slip and fall, resulting in possibly serious personal injury.



WARNING!

Do not wear loose clothing, scarves, or jewelry. They can be caught in moving parts and cause death or serious personal injury.

WARNING!

Keep all snow discharge pointed away from all electrical devices to reduce the risk of electrocution or electric shock.

WARNING!

Never point the snow blower or discharge chute in the direction of people or pets. Thrown snow or other objects can cause serious personal injuries.

WARNING!

Make sure that the area to be cleared is free of stones, sticks, wires, gravel, and other objects that could be accidentally thrown by the snow blower in any direction and cause serious personal injury to the operator and others.

WARNING!

Never reach into the discharge chute or place any body part in front of the snow blower when the unit is operating or when the battery pack(s) are installed. Always ensure all moving parts have stopped and the battery pack(s) have been removed before clearing any obstructions. Failure to follow these instructions can result in serious personal injury.

- If the unit comes in contact with any type of obstruction or debris during use, stop the snow blower, remove the battery pack(s), remove the obstruction, and inspect the unit carefully for damage before proceeding.
- Take notice of the direction of the wind before beginning. When possible, discharge snow in the same direction as the wind to prevent snow from being thrown back into your face.
- Some parts of the snow blower can freeze under extreme weather conditions. Do not attempt to operate the unit with frozen parts.
- When finished, allow the motor to run for an additional few minutes to prevent moving parts from freezing, then turn the chute rotation handle back and forth several times to free it from any ice buildup. Make sure to clean off any snow and ice from the base of the chute.

MAINTENANCE

WARNING!

Always switch the product off, remove the battery packs from the product and let the product cool down before performing any cleaning and maintenance work!

WARNING!

Only perform cleaning and maintenance work according to these instructions! All further works must be performed by a qualified specialist! And only use specified spare parts for replacement.

WARNING!

When servicing, use only identical replacement parts. Use of any other parts may create a hazard or cause product damage. To ensure safety and reliability, all repairs should be performed by a qualified service technician.

NOTE:

Periodically inspect the entire product for damaged, missing, or loose parts such as screws, nuts, bolts, caps, etc. Tighten securely all fasteners and caps and do not operate this product until all missing or damaged parts are replaced.

GENERAL MAINTENANCE

Avoid using solvents when cleaning plastic parts. Most plastics are susceptible to damage from various types of commercial solvents and may be damaged by their use. Use clean cloths to remove dirt, dust, oil, grease, etc.

WARNING!

Do not at any time let brake fluids, gasoline, petroleum-based products, penetrating oils, etc., come in contact with plastic parts. Chemicals can damage, weaken or destroy plastic which may result in serious personal injury.

REPLACING THE SCRAPER BAR

WARNING!

Make sure to turn off the unit and remove the battery pack(s) before performing any maintenance task on your snow blower.

1. The scraper bar is located at the bottom of the snow blower deck, beneath the auger.

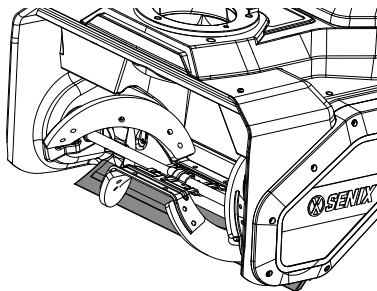

Fig. 15

2. Turn the snow blower on its side.
3. Remove the set of the bolt and nut on each side of the scraper bar. Remove the spring and detach the worn scraper bar from the snow blower.

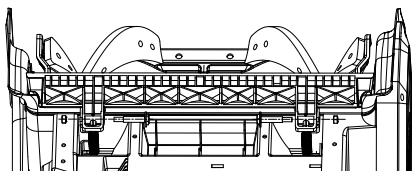

Fig. 16

4. Attach the new scraper bar to the snow blower with the shiny surface facing the inside of the deck.
5. Reinstall the sets of bolt and nut and the spring.

REPLACING THE RUBBER PADDLES & RUBBER AUGERS

If the rubber paddles and rubber augers become worn, excessively cracked, frayed, or otherwise damaged, replace them.

WARNING!

Make sure to turn off the unit and remove the battery pack(s) before performing any maintenance task on your snow blower.

To replace the rubber paddles:

1. Wear gloves. Manually rotate the steel auger to the appropriate position for easy rubber paddle disassembly.
2. Remove all securing bolts and nuts (2 sets of bolts and nuts on each paddle (total of 4 sets)) to take the rubber paddles out.

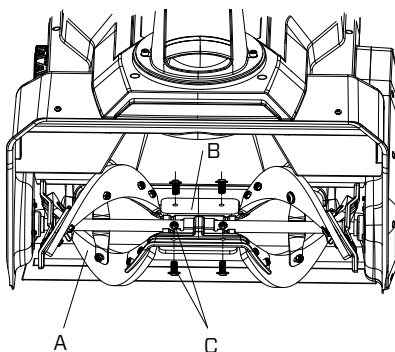

Fig. 17

A	Rubber auger
B	Ruger paddle
C	Set of bolt and nut

3. Replace them with the new rubber paddles, and securely tighten them.

To replace the rubber augers:

1. Wear gloves. Manually rotate the auger to the appropriate position for easy rubber auger disassembly.
2. Remove all securing bolts and nuts (5 sets of bolts and nuts on each paddle (total of 20 sets)) to take the rubber augers out.

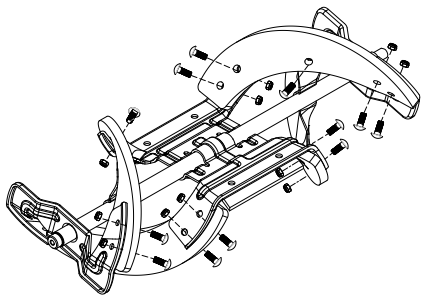

Fig. 18

3. Replace them with the new rubber augers, and securely tighten them.

REPLACING THE DRIVE BELT

If the drive belt becomes worn, oilsoaked, excessively cracked, frayed, or otherwise damaged, replace the belt.

WARNING!

Make sure to turn off the unit and remove the battery pack(s) before performing any maintenance task on your snow blower.

1. Remove the 7 screws to disassemble the left side cover.

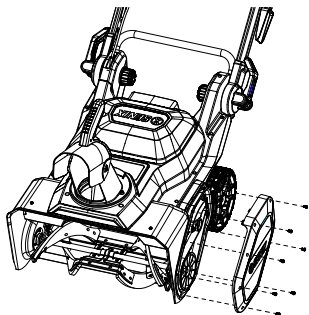

Fig. 19

2. Use needle nose pliers (not included) to remove the spring from the hook to release the belt tension.

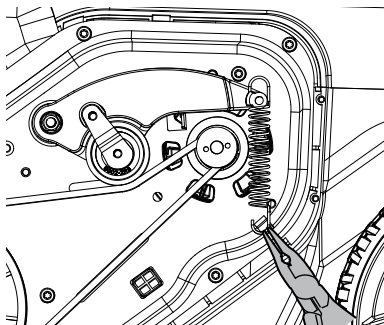

Fig. 20

3. Remove the drive belt by slowly turning the auger pulley counterclockwise while pulling the belt outwards.

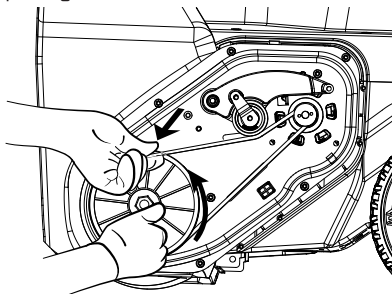

Fig. 21

4. Install the new drive belt by rotating it onto the pulleys.



NOTE:

Rotate the new drive belt first around the motor pulley, then the idler pulley, and finally, around the auger pulley. Slowly turn the auger pulley clockwise to drive the belt inwards.

1. Use needle nose pliers (not included) to install the spring onto the hook to tension the drive belt.
2. Reinstall the drive belt cover and secure it with the 9 screws removed in step 1.

LIFETIME LUBRICATION

Lubrication is not necessary and may damage the product. The lawn mower is lubricated for lifetime use at the factory before shipment.

CLEANING

- Switch the product off, pull out the battery pack from the product.
- Use a clean dry cloth to clean the outside of the product. Do not use strong detergents. Household cleaners that contain aromatic oils such as pine and lemon, and solvents such as kerosene, can damage plastic. Wipe off any moisture with a soft cloth.
- The underside of mower deck should be cleaned after each use to avoid dirt and other debris accumulating.
- If the auger is blocked by foreign objects during the operating, stop the product, wait for the auger stops entirely, remove the foreign objects and clean the auger.
- Make sure to clean off any snow and ice from the base of the chute.
- Use the clean out tool attached to the machine to remove snow build-up in your electric snow blower's chute.

STORAGE



WARNING!

Ensure that all melted snow that may drip from the snow blower is properly wiped up to prevent a slip and fall hazard.

- Remove the battery pack(s) and store in a secure location out of the reach of children.
- Before storage, wipe any moisture, dirt, or debris from and around the battery compartment.
- Clean the snow blower as described earlier.
- Check all nuts, bolts, knobs, screws, etc., for tightness.
- Inspect moving parts for damage, breakage, and wear. Have repairs made on any damaged or missing parts.
- Store the snow blower in a clean, dry, enclosed place out of the reach of children.
- Do not store near corrosive materials such as fertilizer or rock salt.
- Store the snow blower with clean tool attached.

The side rails should be folded away completely for storage:

Loosen the knobs on both sides and open the quick-release levers on to fold the side rails to the storage position.

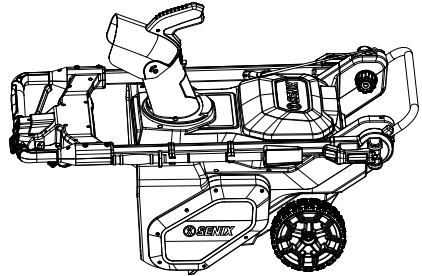

Fig. 22

TRANSPORTATION

- Remove the battery pack(s).
- Clean the product and fold the side rails as described above.
- Lift and carry the unit by grabbing the lift handle with one hand and the lift area, on top of the snow intake with the other hand.
- Always carry the product by its handle.
- Protect the product from any heavy impact or strong vibrations which may occur during transportation in vehicles.

DISPOSAL

Waste product should not be disposed of with household waste. Please recycle where facilities exist. Check with your local authority or retailer for recycling advice. Users should clean up dust generated during operation to protect environment.



Electrical products should not be discarded with household products. Used electrical products must be collected separately and disposed of at collection points provided for this purpose. Talk with your local authorities or dealer for advice on recycling.

TROUBLESHOOTING

Suspected malfunctions are often due to causes that can be addressed by the user. Therefore, troubleshoot the product using this section. In most cases the problem can be solved quickly.

PROBLEM	POSSIBLE CAUSE	SOLUTION
Side rails don't stay in position.	Lock knobs on the side rails and/or quick-release levers are not secured.	Make sure that lock knobs on the side rails are fully tightened and the quick-release levers are fully closed.
Snow blower is not starting.	Battery charge is low.	Charge the battery.
	The auger is jammed, frozen by snow or ice.	Remove the battery pack(s) first, then use a clean-out tool to clear any foreign objects, snow or ice that obstruct the auger. Reinstall the battery packs and restart the snow blower.
	The battery pack is overheated.	Remove the overheated battery pack(s) from the snow blower and wait until the battery pack(s) cools down to normal temperature. Reinstall the battery pack(s) and restart the snow blower.
	Incorrect steps made to power on the snow blower.	Refer to the instructions in the section "STARTING/STOPPING THE SNOW BLOWER" in this manual to start the snow blower.
	Unidentified fault.	Contact a service center for repair.
The motor is on but the auger does not turn.	The drive belt is worn or broken.	Replace with a new one.
After passing, the snow blower leaves a layer of snow on the ground.	The scraper bar is worn.	Replace with a new one.
The snow blower throws less snow.	The rubber paddles are worn.	Replace with a new one.
	Auger speed may be too low.	Increase the auger speed.

The auger fails to get traction and it requires extra effort to push the snow blower forward.	The rubber augers are worn.	Replace with new ones.
The grip area fails to be heated.	The heating function will turn off automatically when the snow blower is inactive for 10 minutes.	Press the grip-heated handles button to restart the heating.

WARRANTY

SENIX TOOLS LIMITED WARRANTY

FOR FIVE YEARS from the date of original purchase this product is warranted against defects in material or workmanship. **WITH PROOF OF ORIGINAL PURCHASE** a defective product will receive free repair. If the product cannot be repaired it will be replaced free of charge.

For details to obtain warranty coverage, visit **senixtools.com**, email **senix.support@yatusa.com** or call **1-800-261-3981**.

- This warranty does not cover repairs necessary due to product accident or abuse, or failure to operate or maintain the product according to all supplied instructions.
- This warranty does not cover an included battery pack or charger, which offer three-year, replacement-only coverage. See battery pack or charger instruction manuals for complete warranty details.
- This warranty does not cover expendable items that can wear out from normal use within the warranty period, including but not limited to drill bits, cutting blades and trimmer spool or line.
- This warranty does not apply to damage resulting from repairs to the product made or attempted by other than SENIX authorized agents.
- This warranty does not cover the cost of mailing or transporting the power tool to receive warranty coverage.
- The warranty is void if the product has been used for commercial, professional, or rental service purposes.
- The warranty applies to the original retail purchaser and is not transferable.
- Proof of purchase is required to obtain warranty coverage.

THIS WARRANTY IS GIVEN IN LIEU OF ALL OTHERS, INCLUDING THE IMPLIED WARRANTY OF MERCHANTABILITY AND FITNESS FOR A PARTICULAR PURPOSE, AND EXCLUDES ALL INCIDENTAL OR CONSEQUENTIAL DAMAGE.

Some states do not allow limitations on how long an implied warranty lasts or the exclusion or limitation of incidental or consequential damages, so these limitations may not apply to you. This warranty gives you specific legal rights and you may have other rights which vary in certain states or provinces.

NOTE: Battery pack warranty voided if the battery pack is tampered with in any way. SENIX is not responsible for any injury caused by tampering and may prosecute warranty fraud to the fullest extent permitted by law.

60-DAY MONEY-BACK GUARANTEE. If for any reason within 60 days from the date of original purchase you are not completely satisfied with the performance of this SENIX product, you can return it with the original sales receipt for a full refund.

Latin America: This warranty does not apply to products sold in Latin America. For products sold in Latin America, see the country-specific warranty information contained in the packaging, call the retailer from which it was purchased, or visit the website for warranty information.

Free warning label replacement: If your warning labels become illegible or are missing, call **1-800-261-3981** for a free replacement.

REGISTER ONLINE - www.senixtools.com/pages/product-registration

Thank you for your purchase! Register your product now for:

Warranty Service: Registering your product will help you obtain more efficient warranty service in case of a problem with your product.

Confirmation of Ownership: In case of an insurance loss, such as fire, flood, or theft, your ownership registration will serve as proof of purchase.

For your safety: Registering your product will allow us to contact you in the unlikely event a safety notification is required under the Federal Consumer Safety Act.



YAT USA INC. 10506 Bryton Corporate Center Dr, #500 Huntersville, NC 28078

For customer support, please call **1-800-261-3981** or email us at **senix.support@yatusa.com**