

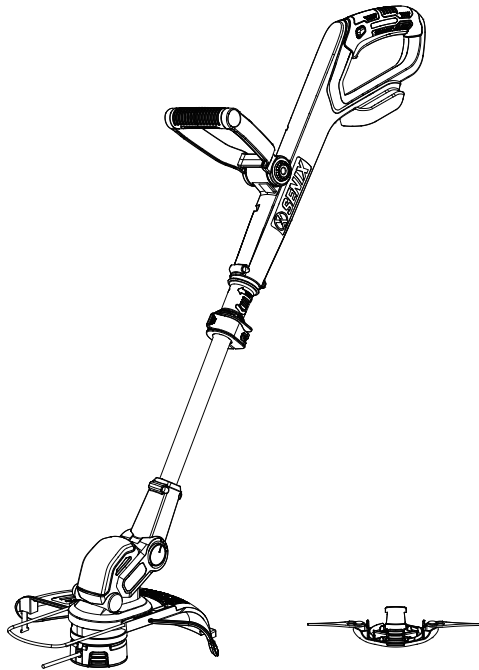

CORDLESS LAWN TRIMMER

GTX2-M2-EU



CAUTION: Before using this tool, please read this manual completely, and follow all operating safety measures.



For customer service please find all information on www.senixtools.com
CAUTION: BEFORE USING THIS PRODUCT, READ THIS MANUAL AND FOLLOW ALL ITS SAFETY RULES AND OPERATING INSTRUCTIONS.

ORIGINAL INSTRUCTIONS

TABLE OF CONTENTS

SAFETY & INTERNATIONAL SYMBOLS	2
SAFETY INSTRUCTIONS.....	3
KNOWYOURUNIT.....	7
SPECIFICATIONS.....	8
ASSEMBLY.....	9
OPERATION.....	11
MAINTENANCE.....	13
TROUBLESHOOTING.....	15

SAFETY & INTERNATIONAL SYMBOLS

The following table depicts and describes safety symbols that may appear on this product. Read, understand and follow all instructions on the machine before attempting to assemble and operate.



Caution / Warning.



WARNING - Beware of thrown objects.



To reduce the risk of injury, user must read instruction manual.



WARNING - The distance between the machine and bystanders shall be at least 15m (50 ft).



Wear eye protection.



Do not use metal blades.



WARNING - Disconnect battery before maintenance.



Wear hearing protection.



Guaranteed Sound power level 95 dB(A).



Wear protective gloves.



Wear sturdy, non-slip footwear.



Do not use in rain or wet conditions.



Keep bystanders a safe distance away from the work area.

SAFETY INSTRUCTIONS

GENERAL POWER TOOL SAFETY WARNINGS



WARNING!

Read all safety warnings, instructions, illustrations and specifications provided with this power tool. Failure to follow all instructions listed below may result in electric shock, fire and/or serious injury.

Save all warnings and instructions for future reference.

The term "power tool" in the warnings refers to your mains-operated (corded) power tool or battery-operated (cordless) power tool.

1) Work area safety

- a) **Keep work area clean and well lit.** Cluttered or dark areas invite accidents.
- b) **Do not operate power tools in explosive atmospheres, such as in the presence of flammable liquids, gases or dust.** Power tools create sparks which may ignite the dust or fumes.
- c) **Keep children and bystanders away while operating a power tool.** Distractions can cause you to lose control.

2) Electrical safety

- a) **Power tool plugs must match the outlet.** Never modify the plug in any way. Do not use any adapter plugs with earthed (grounded) power tools. Unmodified plugs and matching outlets will reduce risk of electric shock.
- b) **Avoid body contact with earthed or grounded surfaces, such as pipes, radiators, ranges and refrigerators.** There is an increased risk of electric shock if your body is earthed or grounded.
- c) **Do not expose power tools to rain or wet conditions.** Water entering a power tool will increase the risk of electric shock.
- d) **Do not abuse the cord.** Never use the cord for carrying, pulling or unplugging the power tool. Keep cord away from heat, oil, sharp edges or moving parts. Damaged or entangled cords increase the risk of electric shock.
- e) **When operating a power tool outdoors, use an extension cord suitable for outdoor use.** Use of a cord suitable for outdoor use reduces the risk of electric

shock.

- f) **If operating a power tool in a damp location is unavoidable, use a residual current device (RCD) protected supply.** Use of an RCD reduces the risk of electric shock.

NOTE The term "residual current device (RCD)" can be replaced by the term "ground fault circuit interrupter (GFCI)" or "earth leakage circuit breaker (ELCB)".

3) Personal safety

- a) **Stay alert, watch what you are doing and use common sense when operating a power tool. Do not use a power tool while you are tired or under the influence of drugs, alcohol or medication.** A moment of inattention while operating power tools may result in serious personal injury.
- b) **Use personal protective equipment. Always wear eye protection.** Protective equipment such as a dust mask, non-skid safety shoes, hard hat or hearing protection used for appropriate conditions will reduce personal injuries.
- c) **Prevent unintentional starting. Ensure the switch is in the off-position before connecting to power source and/or battery pack, picking up or carrying the tool.** Carrying power tools with your finger on the switch or energising power tools that have the switch on invites accidents.
- d) **Remove any adjusting key or wrench before turning the power tool on.** A wrench or a key left attached to a rotating part of the power tool may result in personal injury.
- e) **Do not overreach. Keep proper footing and balance at all times.** This enables better control of the power tool in unexpected situations.
- f) **Dress properly. Do not wear loose clothing or jewellery. Keep your hair and clothing away from moving parts.** Loose clothes, jewellery or long hair can be caught in moving parts.
- g) **If devices are provided for the connection of dust extraction and collection facilities, ensure these are connected and properly used.** Use of dust collection can reduce dust-related hazards.
- h) **Do not let familiarity gained from frequent use of tools allow you to become complacent and ignore tool safety**

principles. A careless action can cause severe injury within a fraction of a second.

4) Power tool use and care

- a) **Do not force the power tool. Use the correct power tool for your application.**
The correct power tool will do the job better and safer at the rate for which it was designed.
- b) **Do not use the power tool if the switch does not turn it on and off.** *Any power tool that cannot be controlled with the switch is dangerous and must be repaired.*
- c) **Disconnect the plug from the power source and/or remove the battery pack, if detachable, from the power tool before making any adjustments, changing accessories, or storing power tools.** *Such preventive safety measures reduce the risk of starting the power tool accidentally.*
- d) **Store idle power tools out of the reach of children and do not allow persons unfamiliar with the power tool or these instructions to operate the power tool.** *Power tools are dangerous in the hands of untrained users.*
- e) **Maintain power tools and accessories. Check for misalignment or binding of moving parts, breakage of parts and any other condition that may affect the power tool's operation. If damaged, have the power tool repaired before use.** *Many accidents are caused by poorly maintained power tools.*
- f) **Keep cutting tools sharp and clean.** *Properly maintained cutting tools with sharp cutting edges are less likely to bind and are easier to control.*
- g) **Use the power tool, accessories and tool bits etc. in accordance with these instructions, taking into account the working conditions and the work to be performed.** *Use of the power tool for operations different from those intended could result in a hazardous situation.*
- h) **Keep handles and grasping surfaces dry, clean and free from oil and grease.** *Slippery handles and grasping surfaces do not allow for safe handling and control of the tool in unexpected situations.*

5) Battery tool use and care

- a) **Recharge only with the charger specified by the manufacturer.** *A charger that is suitable for one type of battery pack may create a risk of fire when used with another*

battery pack.

- b) **Use power tools only with specifically designated battery packs.** *Use of any other battery packs may create a risk of injury and fire.*
- c) **When battery pack is not in use, keep it away from other metal objects, like paper clips, coins, keys, nails, screws or other small metal objects, that can make a connection from one terminal to another.** *Shorting the battery terminals together may cause burns or a fire.*
- d) **Under abusive conditions, liquid may be ejected from the battery; avoid contact.** *If contact accidentally occurs, flush with water. If liquid contacts eyes, additionally seek medical help. Liquid ejected from the battery may cause irritation or burns.*
- e) **Do not use a battery pack or tool that is damaged or modified.** *Damaged or modified batteries may exhibit unpredictable behaviour resulting in fire, explosion or risk of injury.*
- f) **Do not expose a battery pack or tool to fire or excessive temperature.** *Exposure to fire or temperature above 130 °C may cause explosion.*
- g) **Follow all charging instructions and do not charge the battery pack or tool outside the temperature range specified in the instructions.** *Charging improperly or at temperatures outside the specified range may damage the battery and increase the risk of fire.*

6) Service

- a) **Have your power tool serviced by a qualified repair person using only identical replacement parts.** *This will ensure that the safety of the power tool is maintained.*
- b) **Never service damaged battery packs.** *Service of battery packs should only be performed by the manufacturer or authorized service providers.*



WARNING!

Only use following batteries: B20X2/B25X2/B40X2/B50X2/B60X2/B80X2 and chargers: CHX2-L-EU/CHX2-EU/CHQX2-EU/CHQX2-M-EU/CHDX2-M-EU.

LAWN TRIMMER SAFETY

WARNINGS

- a) **Do not use the machine in bad weather conditions, especially when there is a risk of lightning.** This decreases the risk of being struck by lightning.
- b) **Thoroughly inspect the area for wildlife where the machine is to be used.** Wildlife may be injured by the machine during operation.
- c) **Thoroughly inspect the area where the machine is to be used and remove all stones, stick,wires, bones, and other foreign objects.** Thrown objects can cause personal injury.
- d) **Before using the machine, always visually inspect to see that the cutter or blade andthe cutter or blade assembly are not damaged.** Damaged parts increase the risk of injury.
- e) **Follow instructions for changing accessories.** Improperly tightened blade securing nuts or bolts may either damage the blade or result in it becoming detached.
- f) **The rated rotational speed of the blade must be at least equal to the maximum rotational speed marked on the machine.** Blades running faster than their rated rotational speed can break and fly apart.
- g) **Wear eye, ear, head and hand protection.** Adequate protective equipment will reduce personal injury by flying debris or accidental contact with the cutting line or blade.
- h) **While operating the machine, always wear non-slip and protective footwear. Do not operate the machine when barefoot or wearing open sandals.** This reduces the chance of injury to the feet from contact with the moving cutters or lines.
- i) **While operating the machine, always wear safety footwear. Do not operate the machine when barefoot or wearing open sandals.** This reduces the chance of injury to the feet from contact with a moving cutter, line or blade.
- j) **While operating the machine, always wear long trousers.** Exposed skin increases the likelihood of injury from thrown objects.
- k) **Keep bystanders away while operating the machine.** Thrown debris can result in serious personal injury.
- l) **Always use two hands when operating the machine.** Holding the machine with both hands will avoid loss of control.
- m) **Hold the machine by insulated gripping surfaces only, because the cutting line or blade may contact hidden wiring.** Cutting line or blades contacting a "live" wire may make exposed metal parts of the machine "live" and could give the operator an electric shock.
- n) **Always keep proper footing and operate the machine only when standing on the ground.** Slippery or unstable surfaces may cause a loss of balance or control of the machine.
- o) **Do not operate the machine on excessively steep slopes.** This reduces the risk of loss of control, slipping and falling which may result in personal injury.
- p) **When working on slopes, always be sure of your footing, always work across the face of slopes, never up or down and exercise extreme caution when changing direction.** This reduces the risk of loss of control, slipping and falling which may result in personal injury.
- q) **Keep all parts of the body away from the cutter, line or blade when the machine is operating. Before you start the machine, make sure the cutter, line or blade is not contacting anything.** A moment of inattention while operating the machine may result in injury to yourself or others.
- r) **Do not operate the machine above waist height.** This helps prevent unintended cutter or blade contact and enables better control of the machine in unexpected situations.
- s) **When cutting brush or saplings that are under tension, be alert for spring back.** When the tension in the wood fibres is released, the brush or sapling may strike the operator and/or throw the machine out of control.
- t) **Use extreme caution when cutting brush and saplings.** The slender material may catch the blade and be whipped toward you or pull you off balance.
- u) **Maintain control of the machine and do not touch cutters, lines or blades and other hazardous moving parts while they are still in motion.** This reduces the risk of injury from moving parts.
- v) **Carry the machine with the machine switched off and away from your body.** Proper handling of the machine will reduce the likelihood of accidental contact with a moving cutter, line or blade.
- w) **When transporting or storing the machine, always fit the cover on metal blades.** Proper handling of the machine will

reduce the likelihood of accidental contact with the blade.

- x) **Only use replacement cutters, lines, cutting heads and blades specified by the manufacturer.** Incorrect replacement parts may increase the risk of breakage and injury.
- y) **When clearing jammed material or servicing the machine, make sure the switch is off and the machine is disabled.** Unexpected starting of the machine while clearing jammed material or servicing may result in serious personal injury.

BLADE THRUST CAUSES AND RELATED WARNINGS

Blade thrust is a sudden sideways, forward or backward motion of the machine, which may occur when the blade jams or catches on an object such as a sapling or a tree stump. It can be violent enough to cause the machine and/or operator to be propelled in any direction, and possibly lose control of the machine.

Blade thrust and its related hazards can be avoided by taking proper precautions as given below.

- a) **Maintain a firm grip with both hands on the machine and position your arms to resist blade thrust. Position your body to the left side of the machine.** *Blade thrust can increase the risk of injury due to the machine moving unexpectedly. Blade thrust can be controlled by the operator if proper precautions are taken.*
- b) **If the blade binds, or when interrupting a cut for any reason, switch the machine off and hold the machine motionless in the material until the blade comes to a complete stop. While the blade is binding, never attempt to remove the machine from the material or pull the machine backward while the blade is in motion, otherwise blade thrust may occur.** *Investigate and take corrective actions to eliminate the cause of blade binding.*
- c) **Do not use blunt or damaged blades.** *Blunt or damaged blades increase the risk of jamming or catching on an object, resulting in blade thrust.*
- d) **Always maintain good visibility of the material being cut.** *Blade thrust is more likely to occur in areas where it is difficult to see the material being cut.*
- e) **If you are approached by another person while operating the machine, switch the**

machine off. *There is an increased risk of injury to other persons being struck by the moving blade in the event of blade thrust.*

EMERGENCY

Familiarise yourself with the use of this product by means of this instruction manual. Memorise the safety directions and follow them to the letter. This will help to prevent risks and hazards.

1. Always be alert when using this product, so that you can recognise and handle risks early. Fast intervention can prevent serious injury and damage to property.
2. Switch off and disconnect from the power supply if there are malfunctions. Have the product checked by a qualified professional and repaired, if necessary, before you operate it again.

INTENDED USE

This machine is used to cut grass, light weeds, and other similar vegetation in domestic garden. It is not suitable for commercial applications or for larger open spaces and should not be used for any purpose other than described.

KNOW YOUR UNIT

APPLICATIONS

Model: GTX2-M2-EU

As a lawn trimmer:

Cutting grass, weeds or soft vegetation in domestic garden.

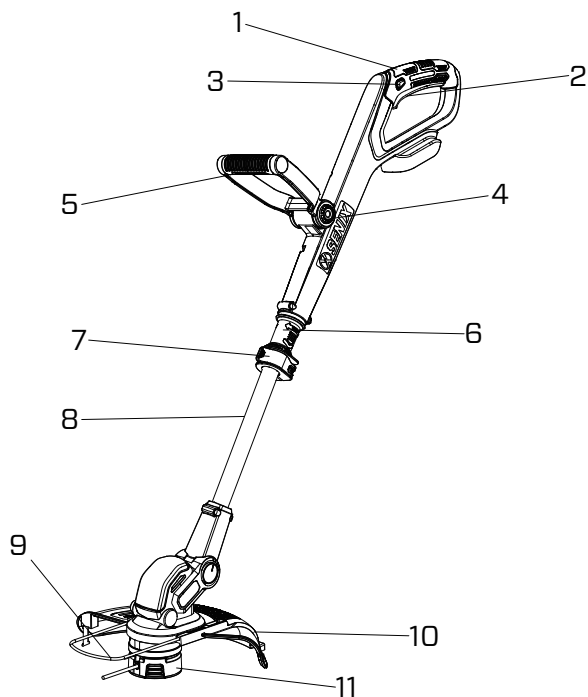

1. Handle
2. Trigger
3. Safety Switch
4. Auxiliary Handle Button
5. Auxiliary Handle
6. Pipe Sleeve

7. Telescoping Lock Clip
8. Pipe
9. Flower Protection
10. Guard
11. Trimmer Head

SPECIFICATIONS

Model	GTX2-M2-EU
Rated Voltage	18 V $\overline{\text{---}}$ (20 V Max*)
No Load Speed	7100 rpm
Line Cutting Capacity	30.5 cm
Plastic Blade Cutting Capacity	25.4 cm
Cutting Line Diameter	1.6 mm
Line Length	5 m
Sound Pressure Value L_{pA} [dB(A)]	83
Sound Power Value L_{wA} [dB(A)]	95
Measurement Uncertainty K_{pA} , K_{wA} [dB(A)]	3
Vibration Total Value	$a_h < 2.5 \text{ m/s}^2$
Uncertainty	$K=1.5 \text{ m/s}^2$
Weight (tool only)	2.15 kg

ASSEMBLY

1. Unpack all parts and lay them on a flat, stable surface:
2. Remove all packing materials and shipping devices, if applicable.
3. The scope of delivery varies depending on the country and purchased variant.

Model of GTX2-M2-EU

- Lawn trimmer x1
- Auxiliary handle x1
- Guard x1
- Screw x1
- Blade holder x1
- Plastic blade x1
- Instruction manual x1

4. If you find that parts are missing or show damage do not use the product but contact your dealer. Using an incomplete or damaged product represents a hazard to people and property.
5. Ensure that you have all the accessories and tools needed for assembly and operation. This also includes suitable personal protective equipment.



WARNING!



Wear protective gloves for this assembly work and always lay the product on a flat and stable surface while assembling.



Follow the assembly instructions step-by-step and use the pictures provided as a visual guide to easily assemble the product!

Do not insert the battery pack before the power tool is completely assembled or adjusted!

INSTALLING THE AUXILIARY HANDLE



WARNING!

To prevent accidental starting that could cause serious personal injury, always remove the battery pack from the tool when installing or adjusting the auxiliary handle.

Keep the auxiliary handle button being pressed and fix the auxiliary handle to the trimmer. Release the button until satisfied position is achieved. Make sure the auxiliary handle is well engaged.

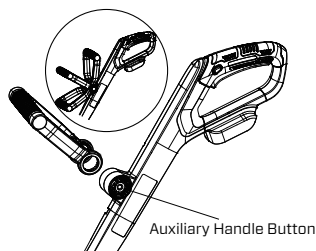

Fig. 1

INSTALLING THE FLOWER PROTECTION

Clip the flower protection into the slots on the guard. Stretch the flower protection for normal use. Push it back when not in use.

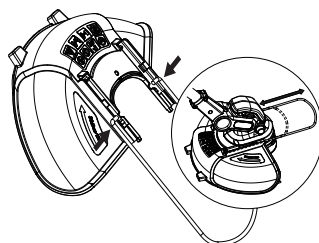

Fig. 2

INSTALLING THE GUARD



WARNING!

Always wear gloves when mounting or replacing the guard. Take care of the blade on the guard and protect your hand from cutting.



WARNING!

To prevent accidental starting that could cause serious personal injury, always remove the battery pack from the tool when installing the guard.

WARNING!

Never operate the tool without the guard firmly in place. The guard must always be on the tool to protect the user!

Slide the guard to the end along the guiding rail. Tighten the screw to lock the guard on the trimmer head. Check the installation to ensure the guard does not fall off.

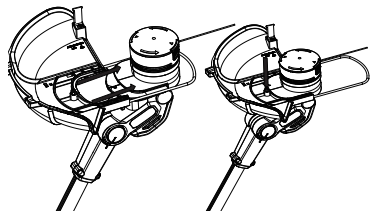

Fig. 3

INSTALLING/REMOVING THE BATTERY PACK

Insert the battery pack to the battery docking port. Ensure the battery pack is well seated. To remove the battery pack, press the battery-release button and pull the battery pack out.

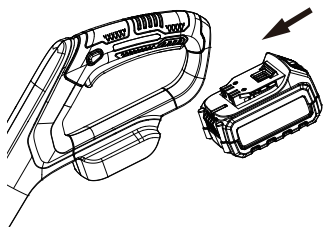

Fig. 4

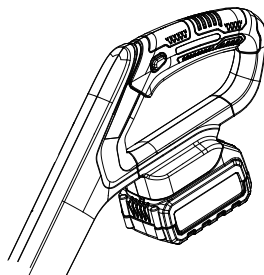

Fig. 5

NOTE:

To obtain the longest possible battery life, charge the battery pack when the ambient temperature is 32 °F (0°C) - 104 °F (40°C).

NOTE:

Refer to the manuals for the charger and battery pack for more details about how the charger to charge the battery pack and other information regarding to the charger and battery pack.

OPERATION



WARNING!

Inspect the tool for complete installation. Any missing, damaged or misplace may cause serious injury.



WARNING!

Dress properly to reduce the risk of injury when operating this tool. Do not wear loose clothing or jewelry. Wear eye and ear/hearing protection. Wear heavy duty, long trousers, boots and gloves. Do not wear short trousers, sandals or go barefoot.

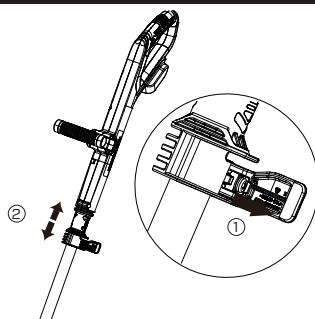

Fig. 7

SWITCHING ON/OFF

1. Push the safety switch at first. Then press the trigger to start. The safety switch can be released once the tool is running.
2. Release the trigger to stop the tool.

Safety Switch

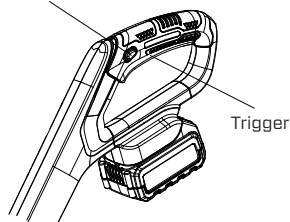

Fig. 6

ADJUSTING THE TRIMMER HEAD

Keep pressing the angle adjustment button and lead the head to an ideal position. Judge the well engagement from a sound of "click". Five optional angles (0-60°) set for meeting your using requirement.

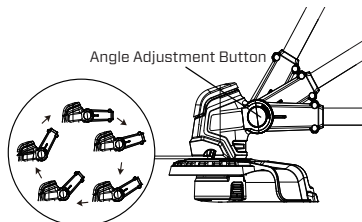

Fig. 8



WARNING!

Always remove the battery pack from the lawn trimmer during work breaks and after finishing work.

ADJUSTING THE PIPE LENGTH

Unlock the telescoping lock clip and stretch the pipe to desired length. Lock again after adjustment.

EDGE TRIMMING

Stretch the pipe sleeve and rotate 180° clockwise. When switched to edge trimming, the pipe will be automatically locked. On the contrary, pull the pipe sleeve again and rotate 180° counterclockwise to resume normal trimming.

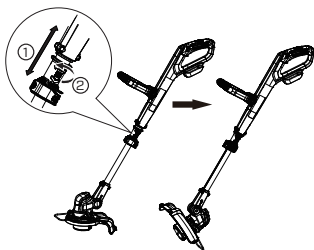

Fig. 9

LINE FEEDING

Semi-automatic line feeding

The trimmer is equipped with a semi-automatic feeding system. The system feeds line with every press of the trigger.

Manual line feeding

Press the line feeding button and manually adjust the line to the desired length.

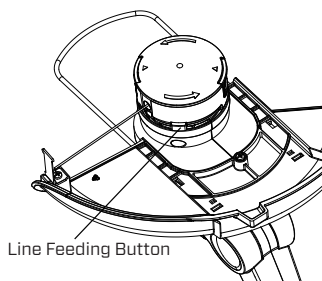

Fig. 10

7. Some line breakage will occur from:

- Entanglement with foreign matter
- Normal line fatigue
- Attempting to cut thick vegetation
- Forcing the line into objects such as walls or fence posts

OVERHEAT PROTECTION

When the tool/battery is overheated, the tool stops automatically. In this situation, let the power tool/battery cool before turning the tool on again.

GENERAL INSTRUCTIONS

1. Stand in the operating position. Stand up straight. Do not bend over. Keep feet apart and firmly planted.
2. Move the trimmer left and right, keeping it well away from the body. Cut all grass from top to down.
3. Inspect the working area and remove all debris that may be entangled in the trimmer head. Also remove any objects that product may throw during cutting.
4. If the trimmer head is wrapped around with grass, stop the trimmer and clean up.
5. Avoid trees, flowers, stones, walls and other objects which can cause the line to break.
6. Check and feed the line regularly to maintain full cutting width and performance.

MAINTENANCE



WARNING!

Remove the battery pack before maintenance!
Wear protective gloves and clothing!
Only perform repairs and maintenance work according to these instructions! All further works must be performed by a qualified specialist! When servicing use only identical replacement parts.

REMOVING THE TRIMMER HEAD

Hold down the spindle lock button so that the spindle does not move. Turn the trimmer head counterclockwise to remove. On the contrary, turn the trimmer head clockwise to install.

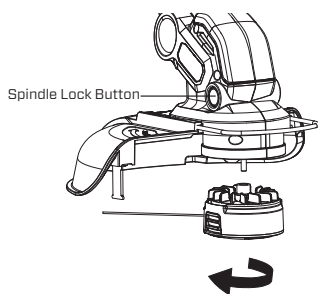

Fig. 11

WINDING THE CUTTING LINE

Press both latches of the spool cover to detach the spool cover. Afterwards, take the empty spool out and clean up remaining line and grass.

Select a proper line comply with "SPECIFICATION" for replacement. Insert one end of the line approx. 02-04 in (5-10mm) into the hole on the spool for line wind-up. Then wind up the line uniformly and tightly according to the indicating arrow on the spool. Lead the other end of the cutting line out of the hole on the spool housing for line guiding. Finally mount the spool back into the trimmer head. Straighten the line and relock the spool cover.

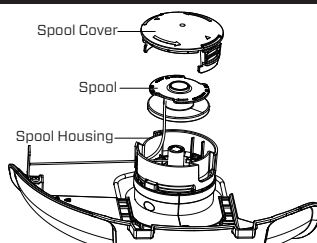

Fig. 12

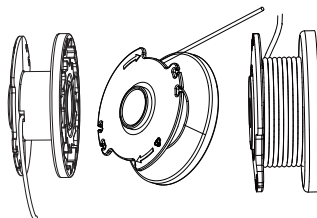

Fig. 13

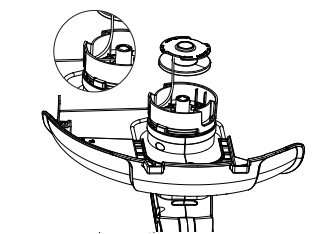
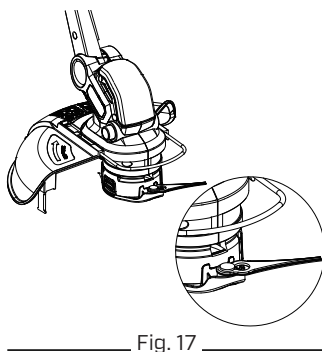
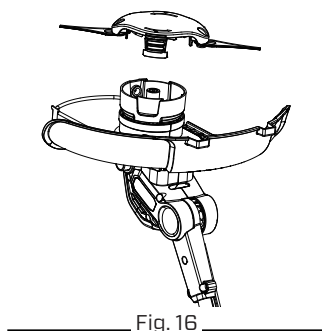
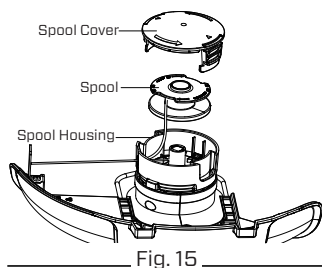

Fig. 14

USING THE PLASTIC BLADE

Press both latches of the spool cover to remove the spool cover. Afterwards, take the spool out and clean up remaining line and grass. Fit the blade holder to spool housing. Clip the rivet into the bigger hole of the plastic blade then move the blade until the rivet secured by the small hole.



CLEANING

- Switch the tool off and remove the battery pack.
- Use a small brush to clean the outside of the unit. Do not use strong detergents. Household cleaners that contain aromatic oils such as pine and lemon, and solvents such as kerosene, can damage plastic.
- Wipe off any moisture with a soft cloth.



NOTE:

If the trimmer head is blocked by foreign

objects during operation, stop the tool, wait till the product stops completely, then remove foreign objects and clean the trimmer head. Clean moving parts may result in hazardous injury.

TRANSPORTATION

- Clean the product as described above.
- Always carry the product by its handle.
- Protect the product from any heavy impact or strong vibrations which may occur during transportation in vehicles.
- Secure the product to prevent it from slipping or falling over, damage or injury.

STORAGE

- Clean the product as described above.
- Store the product and its accessories in a dark, dry, frost-free, well-ventilated place.
- Always store the product in a place that is inaccessible to children. The ideal storage temperature is between 50°F (10°C) and 86°F (30°C).
- We recommend using the original package for wstorage or covering the product with a suitable cloth or enclosure to protect it against dust.



NOTE:

To prolong battery life, store the battery pack separately from the tool in a 30%-50% charged condition. It's recommended to have your battery pack charged at least every 6 months.

DISPOSAL

Waste product should not be disposed of with household waste. Please recycle where facilities exist. Check with your local authority or retailer for recycling advice.

During the operation, the grasses or weeds may be cut by the unit, users should clean these objects to protect environment.



Electrical products should not be discarded with household products. Used electrical products must be collected separately and disposed of at collection points provided for this purpose. Talk with your local authorities or dealer for advice on recycling.

TROUBLESHOOTING

Suspected malfunctions are often due to causes that the users can fix themselves. Therefore, check the product using this section. In most cases the problem can be solved quickly.

Problem	Possible Cause	Solution
Product does not start	Battery pack not properly attached	Attach properly
	Battery too hot/cold	Allow to cool/warm
	Battery pack discharged	Charge the battery pack
Product does not cut	Cutting line too short/broken off	Manually feed cutting line
	Spool empty	Replace line spool
Cutting line can no longer be fed	Line inside the spool entangled	Inspect the spool, rewind if necessary
	Spool empty	Refill cutting line
Heavy vibrations	Cutting system damaged	Have the product repaired by a qualified service
	Grass in spool housing	Disassemble spool cover and remove grass