

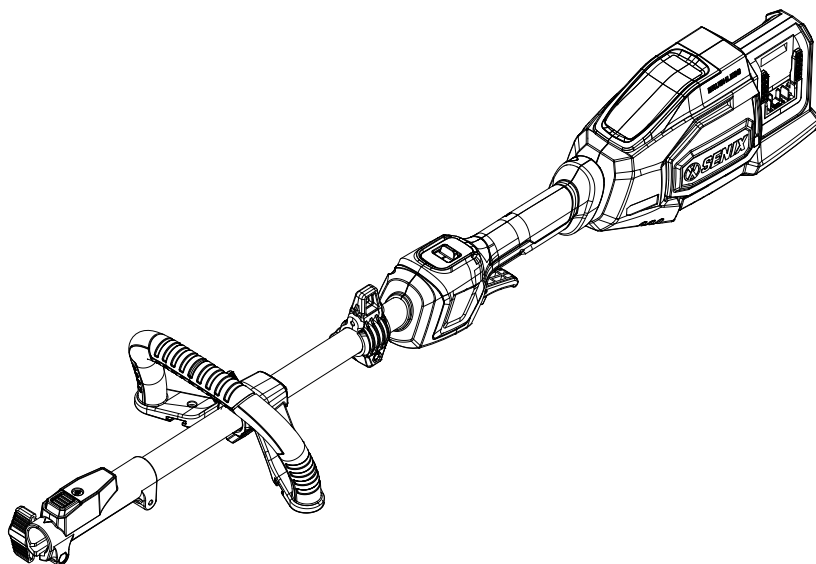

MULTI-FUNCTION MACHINE



CAUTION: Before using this tool, please read this manual completely and follow all operating safety measures.

- SAFETY
- ASSEMBLY
- OPERATION
- MAINTENANCE
- WARRANTY

Zhejiang YAT Electrical Appliance Co., Ltd.
No.150 Wenlong Road, Yuxin Town, Nanhu District, Jiaxing City, Zhejiang Province P.R. China

TABLE OF CONTENTS

SAFETY & INTERNATIONAL SYMBOLS.....	2
SAFETY INSTRUCTIONS.....	3
KNOW YOUR UNIT	5
SPECIFICATIONS*	6
ASSEMBLY.....	6
OPERATION.....	9
MAINTENANCE.....	10
TROUBLESHOOTING.....	12
WARRANTY	13

SAFETY & INTERNATIONAL SYMBOLS

The following table depicts and describes safety and international symbols and pictographs that may appear on this product. Read, understand, and follow all instructions on the machine and in the instruction manual for complete safety, assembly, operating, maintenance, and repair information before attempting to assemble and operate.



Caution / Warning.



To reduce the risk of injury, user must read instruction manual.



Wear eye protection.



Wear hearing protection.



Wear a dust mask.



Do not use in rain or wet conditions.



Wear sturdy, non-slip footwear.



Wear protective gloves.

SAFETY INSTRUCTIONS

GENERAL POWER EQUIPMENT SAFETY WARNINGS



WARNING!

Read all safety warnings, instructions, illustrations and specifications, provided with this power equipment. Failure to follow all instructions listed below may result in electric shock, fire and/or serious injury. Save all warnings and instructions for future reference.

The term “power equipment” in the warnings refers to your mains-operated (corded) power equipment or battery-operated (cordless) power equipment.

1. Work Area Safety

- a. **Keep work area clean and well lit.**
Cluttered or dark areas invite accidents.
- b. **Do not operate power equipment in explosive atmospheres, such as in the presence of flammable liquids, gases or dust.**
Power equipment create sparks which may ignite the dust or fumes.
- c. **Keep children and bystanders away while operating a power equipment.**
Distractions can cause you to lose control.

2. Electrical Safety

- a. **Power equipment plugs must match the outlet. Never modify the plug in any way. Do not use any adapter plugs with earthed (grounded) power equipment.**
Unmodified plugs and matching outlets will reduce risk of electric shock.
- b. **Avoid body contact with earthed or grounded surfaces, such as pipes, radiators, ranges and refrigerators.**
There is an increased risk of electric shock if your body is earthed or grounded.
- c. **Do not expose power equipment to rain or wet conditions.**
Water entering a power equipment will increase the risk of electric shock.
- d. **Do not abuse the cord. Never use the cord for carrying, pulling or unplugging the power equipment. Keep cord away from heat, oil, sharp edges or moving parts.**
Damaged or entangled cords increase the risk of electric shock.
- e. **When operating a power equipment outdoors, use an extension cord suitable**

for outdoor use. *Use of a cord suitable for outdoor use reduces the risk of electric shock.*

- f. **If operating a power equipment in a damp location is unavoidable, use a ground fault circuit interrupter (GFCI) protected supply.** *Use of a GFCI reduces the risk of electric shock.*
- #### 3. Personal Safety
- a. **Stay alert, watch what you are doing and use common sense when operating a power equipment. Do not use a power equipment while you are tired or under the influence of drugs, alcohol or medication.** *A moment of inattention while operating power equipment may result in serious personal injury.*
 - b. **Use personal protective equipment. Always wear eye protection.** *Protective equipment such as a dust mask, non-skid safety shoes, hard hat or hearing protection used for appropriate conditions will reduce personal injuries.*
 - c. **Prevent unintentional starting. Ensure the switch is in the off-position before connecting to power source and/or battery pack, picking up or carrying the equipment.** *Carrying power equipment with your finger on the switch or energizing power equipment that have the switch on invites accidents.*
 - d. **Remove any adjusting key or wrench before turning the power equipment on.** *A wrench or a key left attached to a rotating part of the power equipment may result in personal injury.*
 - e. **Do not overreach. Keep proper footing and balance at all times.** *This enables better control of the power equipment in unexpected situations.*
 - f. **Dress properly. Do not wear loose clothing or jewelry. Keep your hair, clothing and gloves away from moving parts.** *Loose clothes, jewelry or long hair can be caught in moving parts.*
 - g. **If devices are provided for the connection of dust extraction and collection facilities, ensure these are connected and properly used.** *Use of dust collection can reduce dust-related hazards.*
 - h. **Do not let familiarity gained from frequent use of equipment allow you to become complacent and ignore equipment safety principles.** *A careless action can cause severe injury within a fraction of a second.*

4. Power Equipment Use and Care

- a. **Do not force the power equipment. Use the correct power equipment for your application.** *The correct power equipment will do the job better and safer at the rate for which it was designed.*
 - b. **Do not use the power equipment if the switch does not turn it on and off.** *Any power equipment that cannot be controlled with the switch is dangerous and must be repaired.*
 - c. **Disconnect the plug from the power source and/or remove the battery pack, if detachable, from the power equipment before making any adjustments, changing accessories, or storing power equipment.** *Such preventive safety measures reduce the risk of starting the power equipment accidentally.*
 - d. **Store idle power equipment out of the reach of children and do not allow persons unfamiliar with the power equipment or these instructions to operate the power equipment.** *Power equipment are dangerous in the hands of untrained users.*
 - e. **Maintain power equipment and accessories. Check for misalignment or binding of moving parts, breakage of parts and any other condition that may affect the power equipment's operation. If damaged, have the power equipment repaired before use.** *Many accidents are caused by poorly maintained power equipment.*
 - f. **Keep cutting equipment sharp and clean.** *Properly maintained cutting equipment with sharp cutting edges are less likely to bind and are easier to control.*
 - g. **Use the power equipment, accessories and equipment bits etc. in accordance with these instructions, taking into account the working conditions and the work to be performed.** *Use of the power equipment for operations different from those intended could result in a hazardous situation.*
 - h. **Keep handles and grasping surfaces dry, clean and free from oil and grease.** *Slippery handles and grasping surfaces do not allow for safe handling and control of the equipment in unexpected situations.*
- #### 5. Battery Equipment Use and Care
- a. **Recharge only with the charger specified by the manufacturer.** *A charger that is suitable for one type of battery pack*

may create a risk of fire when used with another battery pack.
 - b. **Use power equipment only with specifically designated battery packs.** *Use of any other battery packs may create a risk of injury and fire.*
 - c. **When battery pack is not in use, keep it away from other metal objects, like paper clips, coins, keys, nails, screws or other small metal objects, that can make a connection from one terminal to another.** *Shorting the battery terminals together may cause burns or a fire.*
 - d. **Under abusive conditions, liquid may be ejected from the battery; avoid contact.** *If contact accidentally occurs, flush with water. If liquid contacts eyes, additionally seek medical help. Liquid ejected from the battery may cause irritation or burns.*
 - e. **Do not use a battery pack or equipment that is damaged or modified.** *Damaged or modified batteries may exhibit unpredictable behavior resulting in fire, explosion or risk of injury.*
 - f. **Do not expose a battery pack or equipment to fire or excessive temperature.** *Exposure to fire or temperature above 265 °F (130 °C) may cause explosion.*
 - g. **Follow all charging instructions and do not charge the battery pack or equipment outside the temperature range specified in the instructions.** *Charging improperly or at temperatures outside the specified range may damage the battery and increase the risk of fire.*
- #### 6. Service
- a. **Have your power equipment serviced by a qualified repair person using only identical replacement parts.** *This will ensure that the safety of the power equipment is maintained.*
 - b. **Never service damaged battery packs.** *Service of battery packs should only be performed by the manufacturer or authorized service providers.*

NOTE: ADDITIONAL SPECIFIC SAFETY RULES CAN BE FOUND IN THE APPLICABLE ATTACHMENT'S INSTRUCTION MANUAL.

SAVE THESE INSTRUCTIONS

INTENDED USE

The product is used with only the SENIX attachments.

KNOW YOUR UNIT

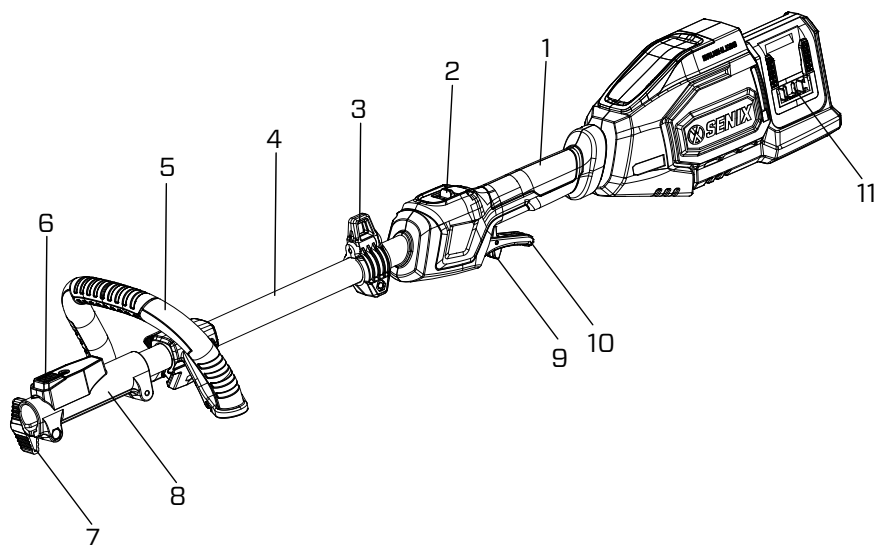

APPLICATIONS

Model: PHX2-M-EU

As a power head:
being used with only the SENIX attachments.

1	Rear Handle
2	Speed Mode Switch
3	Shoulder-strap Loop
4	Power-head Shaft
5	Quick-adjust Front Handle
6	Shaft-release Button

7	Wing Knob
8	Coupler
9	Safety Switch
10	Variable Speed Trigger
11	Electric Contacts

SPECIFICATIONS*

Model	PHX2-M-EU
Rated Voltage	36 V \approx (40 V \approx Max*)
Rated Output Power	1000 W
Motor Type	Brushless
No-Load Speed	6000/7300 RPM
Recommended Operating Temperature	5 °F-104 °F
Recommended Storage Temperature	-4 °F-158 °F
Weight (Tool Only)	3.0 kg

*40V Max battery, maximum initial battery voltage (measured without a workload) is 40V. The nominal voltage is 36V.

Only use the following attachments:

Attachment Type	Model
Grass Trimmer Attachment	AGT006
Brush Cutter Attachmen	ABC002
Hedge Trimmer Attachment	AHTP002
Pole Saw Attachment	ACSP005
Cultivator Attachment	ACT002
Edger Attachment	AET002



NOTE:

Only use the following batteries: B20X2, B25X2, B40X2, B50X2, B80X2 and chargers: CHX2-L1, CHX2, CHQX2, CHQX2-M, CHDX2-M.

ASSEMBLY

- Unpack all parts and lay them on a flat, stable surface:
- Remove all packing materials and shipping devices, if applicable.

- The scope of delivery varies depending on the country and purchased variant.
 - Power head x1
 - Quick-adjust front handle x1
 - Clamping Block x1
 - Wing Nut x1
 - Bolt x1
 - Shoulder strap x1
 - Instruction Manual x1
- If you find that parts are missing or show damage do not use the product but contact your dealer. Using an incomplete or damaged product represents a hazard to people and property.
- Ensure that you have all the accessories and tools needed for assembly and operation. This also includes suitable personal protective equipment.



WARNING!



Wear protective gloves for this assembly work and always lay the product on a flat and stable surface while assembling.



Follow the assembly instructions step-by-step and use the pictures provided as a visual guide to easily assemble the product!
Do not insert the battery pack before the power tool is completely assembled or adjusted!

INSTALLING /REMOVING AN ATTACHMENT



WARNING!

Read and understand entire Instruction Manual for each optional attachment used with this power head and follow all warnings and instructions. Failure to follow all instructions could result in electric shock, fire and/or serious personal injury.



WARNING!

This power head is designed to be used only with the SENIX attachment models that are specified in this Instruction Manual for use with this power head. Use of other unauthorized attachments could cause serious personal injuries or property damage.

WARNING!

Some accessories have specific requirements related to safety. Always pay special attention to such instructions in the manual that accompanies each accessory.

WARNING!

Never install, remove, or adjust any attachment while the power head is running or with the battery installed. Failure to stop the motor and remove the battery can cause serious personal injury. **NEVER OPERATE THE POWER HEAD WITHOUT AN ATTACHMENT.** The attachment connects to the power head by means of a coupler device.

To Install:

1. Loosen the wing knob.
2. Remove the end cap from the attachment. Align the arrow on the attachment shaft with the arrow on the coupler and push the attachment shaft into the coupler until you hear a clear “click” sound. The coupler should be positioned all the way to the **RED LINE** labeled on the shaft for the attachment shaft to be properly mounted in place.

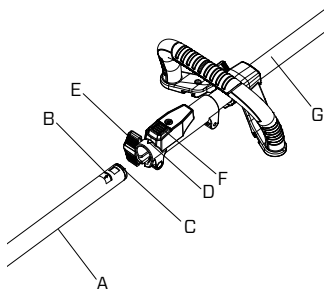

Fig. 1

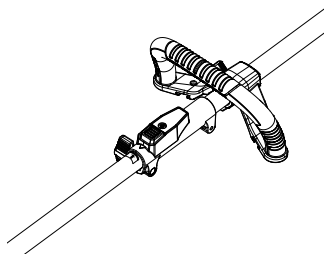

Fig. 2

3. Pull the shaft of the attachment to verify that it is securely locked into the coupler. If not, rotate the attachment shaft from side to side in the coupler until it snaps into place.
4. Tighten the wing knob securely.

WARNING!

Be certain that the wing knob is fully tightened before operating equipment; check it periodically for tightness during use to avoid serious personal injury.

To Remove:

1. Loosen the wing knob.
2. Press the shaft-release button and, with the button depressed, pull or twist the attachment shaft out of the coupler.

A	Attachment Shaft
B	Red Line
C	Arrow on the Attachment Shaft
D	Arrow on the Coupler
E	Wing Knob
F	Shaft-release Button
G	Power-head Shaft

INSTALLING THE HANDLE

WARNING!

Do not attempt to modify this product or create accessories not recommended for use with this power head. Any such alteration or modification is misuse and could result in a hazardous condition leading to possibly serious personal injury.

WARNING!

To prevent accidental starting that could cause serious personal injury, always remove the battery pack from the power head when installing or adjusting the quick-adjust front handle.

WARNING!

Never use this power head without the front handle securely attached.

- 1. Clamp the front handle to the power-head shaft.

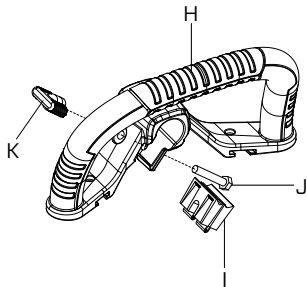

Fig. 3

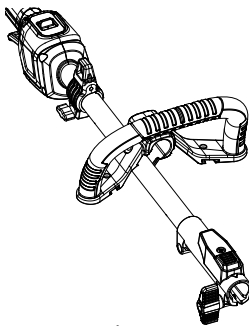

Fig. 4

- 2. Push the clamping block along the tube groove into the handle slot.

! WARNING!

Always use the clamping block correctly and make sure that the handle is not mounted beyond the tube groove.

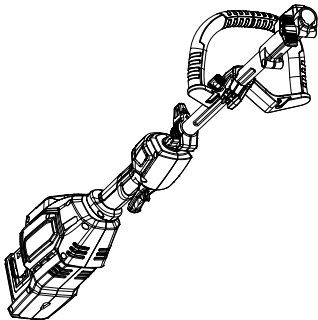

Fig. 5

- 3. Insert the bolt and tighten the wing

nut. Make sure that the front handle is positioned upwards and points toward the coupler.

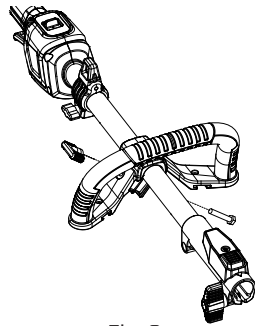

Fig. 6

- 4. The front handle can be adjusted by loosening the nut to make sure your front arm is straight when using the trimmer and then tighten the nut.

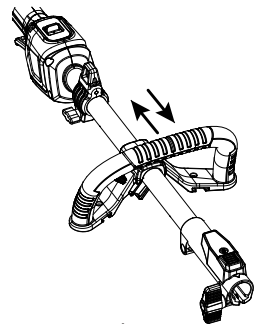

Fig. 7

H	Front Handle
I	Clamping Block
J	Bolt
K	Wing Nut

INSTALLING THE SHOULDER STRAP

Depress the strap carabiner to open it and attach it onto the shoulder-strap loop. Adjust the length of the strap to attain a comfortable working position.

There are three ways to release the strap.

- Take it off from your shoulder directly.
- Depress the carabiner and disconnect the shoulder strap from the shoulder-strap loop.
- Pull down the release cord of the quick-release mechanism under emergencies to take off the strap quickly

When wearing the strap, no other wearable should interfere with the release and removal of the strap.

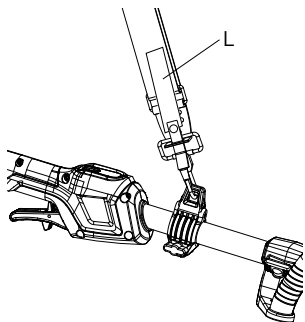

Fig. 8

L	Release Cord
---	--------------

INSTALLING/REMOVING THE BATTERY PACK

To install:

Align and slide the battery pack to the docking port of the tool until it is locked in place.

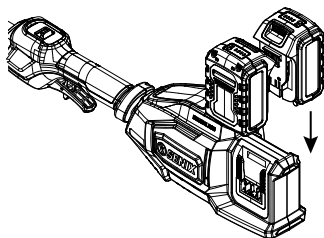

Fig. 9

To remove:

Press the battery-release button on the battery pack and slide the battery pack out.

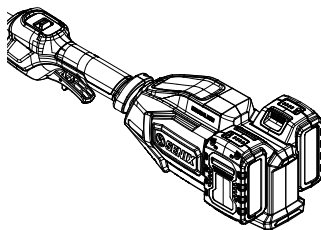

Fig. 10



NOTE:

Refer to the manuals for the charger and battery pack for more details.

OPERATION



WARNING!

Dress properly to reduce the risk of injury when operating this power head. Do not wear loose clothing or jewelry. Wear eye and ear/hearing protection. Wear heavy duty, long trousers, boots and gloves. Do not wear short trousers, sandals or go barefoot.



WARNING!

NEVER OPERATE THE POWER HEAD WITHOUT AN ATTACHMENT. Do not attempt to start the power head without an attachment

SWITCHING ON/OFF

1. To start, push the safety switch forward and depress the trigger.
2. The rotational speed of the power head is controlled with the variable speed trigger. More pressure on the trigger results in higher speed; less pressure on the trigger results in lower speed. Adjust the speed to suit the task at hand.
3. To stop, release the trigger.

MAINTENANCE

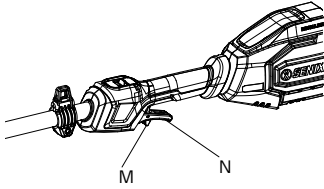

Fig. 11

M	Safety Switch
N	Trigger

WARNING!

Always remove the battery pack from the product during work breaks and after finishing work.

CHANGING SPEED MODE

The power head features two speed modes. Push the speed mode switch to change rotational speed between the low and high.

Refer to the table below for specific speed settings.

Mode	Speed
High	0-7300 RPM
Low	0-6000 RPM

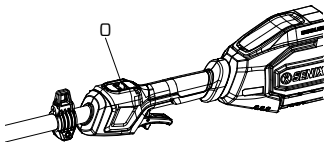

Fig. 12

O	Speed Mode Switch
---	-------------------

WARNING!

Only perform cleaning and maintenance according to these instructions! All further works must be performed by an Authorized Service Center.

WARNING!

TO PREVENT SERIOUS INJURY FROM ACCIDENTAL OPERATION: Make sure the battery pack is removed before performing any procedure in this section.

TO PREVENT SERIOUS INJURY FROM TOOL FAILURE: Do not use damaged equipment or accessories. If abnormal noise or vibration occurs, have the tool inspected and serviced before further use.

There are no user-serviceable parts in your power tool. If any of following condition are found, stop using it and send it to the authorized service center for repair.

- Leaking, swollen, or cracked battery pack.
- Loose hardware.
- Misalignment or binding of accessories.
- Cracked or broken parts.
- Any other condition that may affect its safe operation.

CLEANING

- Use a small brush to clean the outside of the product. Do not use strong detergents. Household cleaners that contain aromatic oils such as pine and lemon, and solvents such as kerosene, can damage plastic.
- Wipe off any moisture with a soft cloth.

WARNING!

Do not use chemical, alkaline, abrasive or other aggressive detergents or disinfectants to clean this product as they might be harmful to its surfaces.

TRANSPORTATION

- Clean the product as described above.
- Always carry the product by its handle.
- Secure the product properly when transporting.

STORAGE

- Clean thoroughly as described above.
- Store in a dark, dry, frost-free and well-ventilated area that is inaccessible to children.
- Use original package for storage or cover with a suitable cloth to protect it against dust.

DISPOSAL

Unwanted product should not be disposed of with household waste. Please recycle where facilities exist. Check with your local authority or retailer for recycling advice. Users should clean up dust generated during operation to protect environment.



Batteries should not be discarded with household products. Used batteries must be collected separately and disposed of at collection points provided for this purpose. Talk with your local authorities or dealer for advice on recycling.

TROUBLESHOOTING

See the applicable attachment's instruction manual.

WARRANTY

SENIX TOOLS LIMITED WARRANTY

FOR FIVE YEARS from the date of original purchase this product is warranted against defects in material or workmanship. WITH PROOF OF ORIGINAL PURCHASE a defective product will receive free repair. If the product cannot be repaired it will be replaced free of charge.

For details to obtain warranty coverage, visit senixtools.com, email senix.support@yatusa.com or call **1-800-261-3981**.

- This warranty does not cover repairs necessary due to product accident or abuse, or failure to operate or maintain the product according to all supplied instructions.
- This warranty does not cover an included battery pack or charger, which offer three-year, replacement-only coverage. See battery pack or charger instruction manuals for complete warranty details.
- This warranty does not cover expendable items that can wear out from normal use within the warranty period, including but not limited to drill bits, cutting blades and trimmer spool or line.
- This warranty does not apply to damage resulting from repairs to the product made or attempted by other than SENIX authorized agents.
- This warranty does not cover the cost of mailing or transporting the power tool to receive warranty coverage.
- The warranty is void if the product has been used for commercial, professional, or rental service purposes.
- The warranty applies to the original retail purchaser and is not transferable.
- Proof of purchase is required to obtain warranty coverage.

THIS WARRANTY IS GIVEN IN LIEU OF ALL OTHERS, INCLUDING THE IMPLIED WARRANTY OF MERCHANTABILITY AND FITNESS FOR A PARTICULAR PURPOSE, AND EXCLUDES ALL INCIDENTAL OR CONSEQUENTIAL DAMAGE.

Some states do not allow limitations on how long an implied warranty lasts or the exclusion or limitation of incidental or consequential damages, so these limitations may not apply to you. This warranty gives you specific legal rights and you may have other rights which vary in certain states or provinces.

NOTE: Battery pack warranty voided if the battery pack is tampered with in any way. SENIX is not responsible for any injury caused by tampering and may prosecute warranty fraud to the fullest extent permitted by law.

60-DAY MONEY-BACK GUARANTEE. If for any reason within 60 days from the date of original purchase you are not completely satisfied with the performance of this SENIX product, you can return it with the original sales receipt for a full refund.

Latin America: This warranty does not apply to products sold in Latin America. For products sold in Latin America, see the country-specific warranty information contained in the packaging, call the retailer from which it was purchased, or visit the website for warranty information.

Free warning label replacement: If your warning labels become illegible or are missing, call **1-800-261-3981** for a free replacement.

REGISTER ONLINE - senixtools.com/pages/product-registration

Thank you for your purchase! Register your product now for:

Warranty Service: Registering your product will help you obtain more efficient warranty service in case of a problem with your product.

Confirmation of Ownership: In case of an insurance loss, such as fire, flood, or theft, your ownership registration will serve as proof of purchase.

For your safety: Registering your product will allow us to contact you in the unlikely event a safety notification is required under the Federal Consumer Safety Act.

