

## Unpacking the Unit

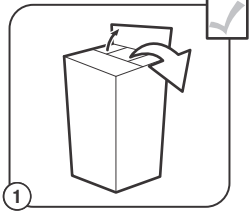

1 Remove all contents from the carton.

## Assembling the Unit

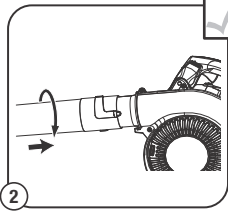

2 Align the slots on the upper end of the upper blower tube with the bumps on the blower outlet. Install the upper blower tube onto the blower outlet. While holding the handle, twist the upper blower tube clockwise until it locks into place.

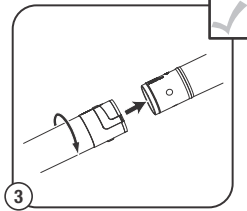

3 Align the slots on the lower blower tube with the bumps on the lower end of the upper blower tube. Install the lower blower tube onto the upper blower tube. While holding the upper blower tube, twist the lower blower tube clockwise until it locks into place.

## Starting the Unit

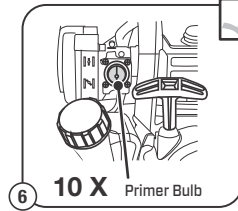

6 **10 X** Primer Bulb

Press the primer bulb 10 times.

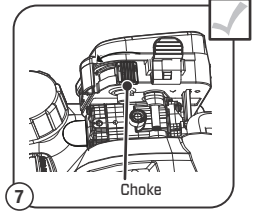

7 Choke

Push the choke button to the FULL choke position.

## Oil and Fuel

**NOTICE:** The blower is shipped without oil in the crankcase. Oil must be added before starting.

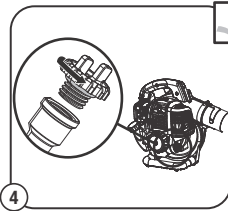

4 Set the unit on a flat, level surface. Unscrew the oil fill plug. Pour the entire container of SAE 30W oil into the oil fill hole. NOTE: DO NOT overfill. Never add oil to the fuel tank. DO NOT mix oil with gasoline.

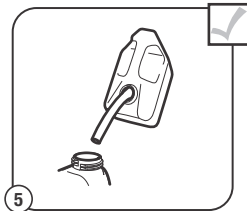

5 Place the unit on a level surface. Remove the fuel cap. Fill the fuel tank. Replace the fuel cap. Move the unit at least 9.1 m (30 ft) from the fuel container and the fueling site before starting the engine. NOTE: Use fresh unleaded gasoline (less than 30 days old).

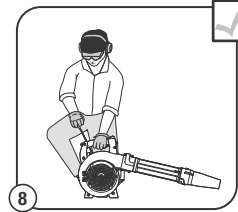

8 Crouch in the starting position.

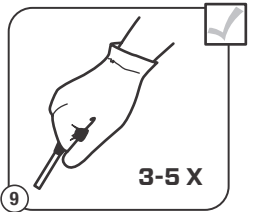

9 **3-5 X**

Pull the starter rope with a controlled and steady motion 3-5 times to start the engine. Allow to warm up no more than 10 seconds before increasing speed.

**DIDN'T START?**  
Repeat the starting instructions. If the unit still fails to start, refer to the operator's manual for additional starting and troubleshooting information.

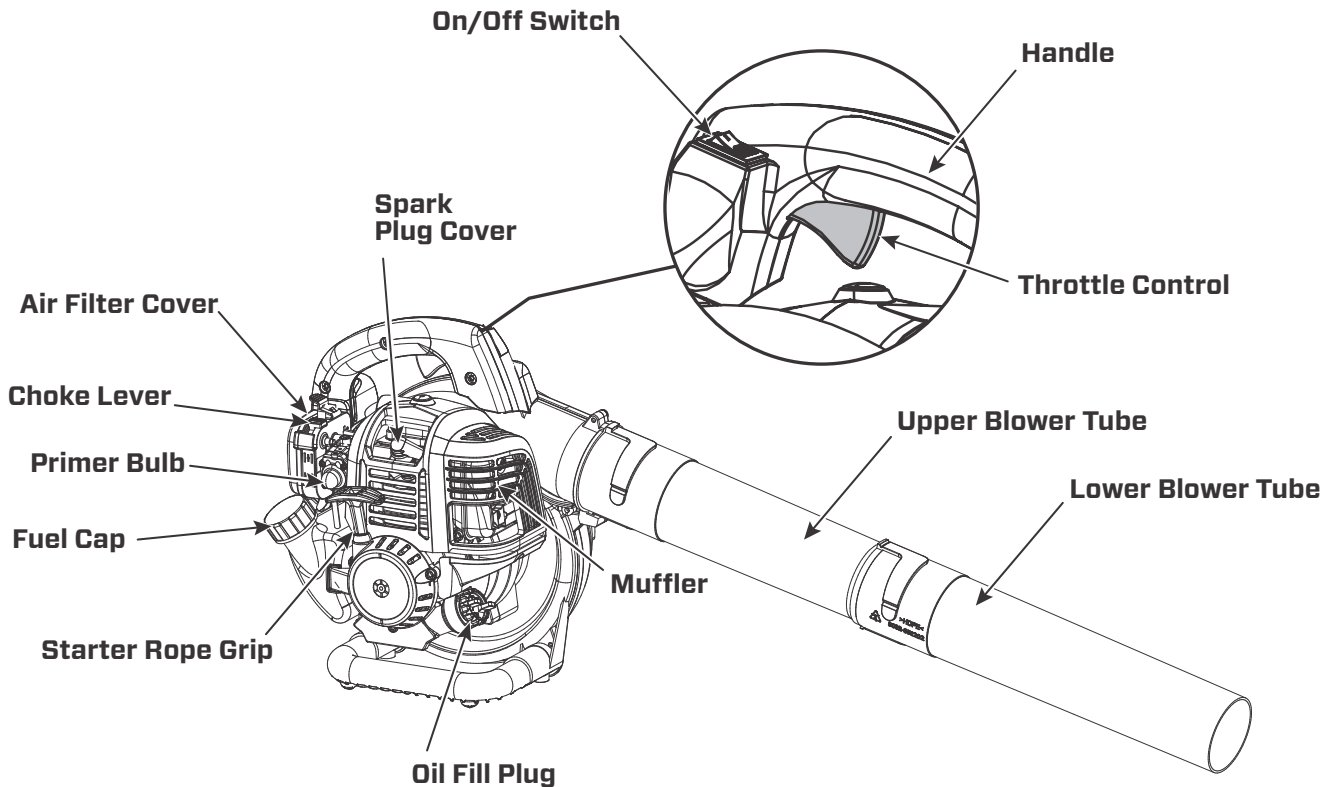

**IMPORTANT: READ THE OPERATOR'S MANUAL THOROUGHLY AND FOLLOW THE SAFE OPERATION PRACTICES WHILE OPERATING THE UNIT.**

